

# Notice of variation and consolidation with introductory note

**The Environmental Permitting (England & Wales) Regulations 2016**

---

Oates Environmental Limited  
Carr Crofts Waste Treatment Facility  
10 Carr Crofts Drive  
Leeds  
West Yorkshire  
LS12 3AL

**Variation application number**

EPR/YP3832WS/V004

**Permit number**

EPR/YP3832WS

# Carr Crofts Waste Treatment Facility

## Permit number EPR/YP3832WS

### Introductory note

#### **This introductory note does not form a part of the notice**

Under the Environmental Permitting (England & Wales) Regulations 2016 (schedule 5, part 1, paragraph 19) a variation may comprise a consolidated permit reflecting the variations and a notice specifying the variations included in that consolidated permit.

Schedule 1 of the notice specifies the conditions that have been varied and schedule 2 comprises a consolidated permit which reflects the variations being made. Only the variations specified in schedule 1 are subject to a right of appeal.

#### **EPR/YP3832WS/V004**

This variation allows an increase in the storage capacity for non-hazardous wastes from 236 tonnes to 670 tonnes, and for hazardous wastes from 396 tonnes to 670 tonnes. It also allows the storage of hazardous and non-hazardous waste outside of the building in a designated purpose built bunded storage bay.

A pre-operational measure has been added that requires the operator to install infrastructure as described in the application, prior to storage of waste outside of the building.

The rest of the installation remains unchanged and is described as follows:

The facility comprises the following activities listed in Schedule 1 of the EP Regulations:

- Section 5.6 Part A(1)(a) - Temporary storage of hazardous waste with a total capacity exceeding 50 tonnes.
- Section 5.3 Part A(1)(a)(ii) - Disposal or recovery of hazardous waste with capacity exceeding 10 tonnes per day involving physico-chemical treatment.
- Section 5.3 Part A(1)(a)(iv) - Disposal or recovery of hazardous waste with capacity exceeding 10 tonnes per day involving repackaging.
- Section 5.4 Part A(1)(a)(ii) - Disposal of non-hazardous waste with a capacity exceeding 50 tonnes per day involving physico-chemical treatment.

And the following waste operations:

- Storage (D15 & R13) and repackaging of non-hazardous waste for disposal or recovery (D14, R3, R4 & R5).

The site is located on Carr Crofts Drive, Leeds (grid ref: SE 26792 33146). The facility comprises a warehouse building with office facilities and a yard area. There are other similar units neighbouring the site, and housing within 50 m to the south and south-east. Several railway tracks run approximately 50 m to the north-west of the site. Part of the Leeds-Liverpool Canal, a site of special scientific interest (SSSI) lies within 2 km of the site, as do several local wildlife sites.

The facility handles both hazardous and non-hazardous waste on site falling primarily in two categories the first being 'packaged waste' such as drummed wastes for storage and repackaging prior to off-site disposal or recovery and secondly 'liquid waste' such as oil/water mixes and leachates for treatment. Liquid waste will be brought to site via road tanker for bulk storage in tanks and then treated via settlement/ separation to remove oil phases and solids, followed by Ultrafiltration (UF). Annual waste throughput is less than 30,000 tonnes/year. Company vehicles are also being cleaned on site in the transport yard in a dedicated contained area and the wash water will be treated via the UF plant. The final UF plant permeate is discharged to sewer whilst the concentrate will be despatched off-site for disposal.

The site surface is concrete, and designed with suitable segregation, secondary and tertiary containment for the types and quantities of wastes handled. The operator works to their own Environment Management System (EMS) based on ISO 14001 principles.

The schedules specify the changes made to the permit.

The status log of a permit sets out the permitting history, including any changes to the permit reference number.

<b>Status log of the permit</b>		
<b>Description</b>	<b>Date</b>	<b>Comments</b>
Application EPR/YP3832WS/A001	Duly made 28/09/2015	-
Schedule 5 Notice dated 05/11/2015	23/11/2015 and 09/12/2015	-
Permit determined EPR/YP3832WS/A001	23/02/2016	Permit issued to Oates Environmental Limited.
Application EPR/YP3832WS/V002 (variation and consolidation)	Duly made 26/05/2016	Application to vary and update the permit to modern conditions.
Variation determined EPR/YP3832WS	14/06/2016	Varied and consolidated permit issued in modern condition format.
Application EPR/YP3832WS/V003 (variation)	Duly made 17/07/2017	Application to add one waste code to the list of permitted wastes
Variation determined EPR/YP3832WS	14/09/2017	Varied permit issued
Application EPR/YP3832WS/V004 (variation and consolidation)	Duly made 06/07/2020	Application to increase waste storage capacity and allow storage of waste outside of the building.
Response to request for information dated 31/07/2020	03/08/2020	Holding area and waste bay infrastructure details.
	04/08/2020	Further information on waste bay infrastructure details.
Variation determined EPR/YP3832WS Billing references: - Installation: KP3909PA - Waste: EAWML 4025883	10/08/2020	Varied permit issued.

End of introductory note

# Notice of variation and consolidation

## The Environmental Permitting (England and Wales) Regulations 2016

The Environment Agency in exercise of its powers under regulation 20 of the Environmental Permitting (England and Wales) Regulations 2016 varies

### Permit number

**EPR/YP3832WS**

### Issued to

**Oates Environmental Limited** (“the operator”)

whose registered office is

**10 Carr Crofts Drive**

**Leeds**

**West Yorkshire**

**LS12 3AL**

company registration number **4005464**

to operate regulated facilities at

**Carr Crofts Waste Treatment Facility**

**10 Carr Crofts Drive**

**Leeds**

**West Yorkshire**

**LS12 3AL**

to the extent set out in the schedules.

The notice shall take effect from 10/08/2020

<b>Name</b>	<b>Date</b>
<b>David Griffiths</b>	<b>10/08/2020</b>

Authorised on behalf of the Environment Agency

## **Schedule 1**

Only the following condition and tables have been varied by the consolidated permit EPR/YP3832WS as a result of the application made by the operator:

- Table S1.1, as referenced in conditions 1.2.1, 1.3.1, 2.1.1, 2.1.2, 2.3.1, 2.3.7 and 4.2.2, has been varied to remove the restriction to store waste inside a building from activity A7.
- Table S1.2, as referenced in conditions 2.3.1 and 2.3.2, has been varied to update the sites operating techniques with respect to storage of waste outside of the building under activities A1 and A7.
- Table S1.4B, as referenced in condition 2.5.2, has been varied to add pre-operational measure prior to future development for the installation of appropriate infrastructure prior to acceptance and storage of waste in the storage bay outside of the building.
- Table S2.2, as referenced in condition 2.3.4, has been varied to increase the waste storage capacities.
- Schedule 7, as referenced in condition 2.2.1, has been varied to include an updated site layout plan.

## **Schedule 2 – consolidated permit**

Consolidated permit issued as a separate document.

# Permit

## The Environmental Permitting (England and Wales) Regulations 2016

### Permit number

**EPR/YP3832WS**

This is the consolidated permit referred to in the variation and consolidation notice for application EPR/YP3832WS/V004 authorising,

**Oates Environmental Limited** (“the operator”),

whose registered office is

**10 Carr Crofts Drive**

**Leeds**

**West Yorkshire**

**LS12 3AL**

company registration number **4005464**

to operate an installation and waste operations at

**Carr Crofts Waste Treatment Facility**

**10 Carr Crofts Drive**

**Leeds**

**West Yorkshire**

**LS12 3AL**

to the extent authorised by and subject to the conditions of this permit.

<b>Name</b>	<b>Date</b>
<b>David Griffiths</b>	<b>10/08/2020</b>

Authorised on behalf of the Environment Agency

# Conditions

## 1 Management

### 1.1 General management

- 1.1.1 The operator shall manage and operate the activities:
- (a) in accordance with a written management system that identifies and minimises risks of pollution, including those arising from operations, maintenance, accidents, incidents, non-conformances, closure and those drawn to the attention of the operator as a result of complaints; and
  - (b) using sufficient competent persons and resources.
- 1.1.2 Records demonstrating compliance with condition 1.1.1 shall be maintained.
- 1.1.3 Any person having duties that are or may be affected by the matters set out in this permit shall have convenient access to a copy of it kept at or near the place where those duties are carried out.
- 1.1.4 The operator shall comply with the requirements of an approved competence scheme.

### 1.2 Energy efficiency

- 1.2.1 For the following activities referenced in schedule 1, table S1.1 (A1 to A6) the operator shall:
- (a) take appropriate measures to ensure that energy is used efficiently in the activities;
  - (b) review and record at least every four years whether there are suitable opportunities to improve the energy efficiency of the activities; and
  - (c) take any further appropriate measures identified by a review.

### 1.3 Efficient use of raw materials

- 1.3.1 For the following activities referenced in schedule 1, table S1.1 (A1 to A6) the operator shall:
- (a) take appropriate measures to ensure that raw materials and water are used efficiently in the activities;
  - (b) maintain records of raw materials and water used in the activities;
  - (c) review and record at least every four years whether there are suitable alternative materials that could reduce environmental impact or opportunities to improve the efficiency of raw material and water use; and
  - (d) take any further appropriate measures identified by a review.

### 1.4 Avoidance, recovery and disposal of wastes produced by the activities

- 1.4.1 The operator shall take appropriate measures to ensure that:
- (a) the waste hierarchy referred to in Article 4 of the Waste Framework Directive is applied to the generation of waste by the activities; and
  - (b) any waste generated by the activities is treated in accordance with the waste hierarchy referred to in Article 4 of the Waste Framework Directive; and
  - (c) where disposal is necessary, this is undertaken in a manner which minimises its impact on the environment.

- 1.4.2 The operator shall review and record at least every four years whether changes to those measures should be made and take any further appropriate measures identified by a review.

## **2 Operations**

### **2.1 Permitted activities**

- 2.1.1 The operator is only authorised to carry out the activities specified in schedule 1, table S1.1 (the “activities”).
- 2.1.2 For the following activities referenced in schedule 1, table S1.1 (A1 to A6) waste authorised by this permit shall be clearly distinguished from any other waste on the site.

### **2.2 The site**

- 2.2.1 The activities shall not extend beyond the site, being the land shown edged in green on the site plan at schedule 7 to this permit.

### **2.3 Operating techniques**

- 2.3.1 For the following activities referenced in schedule 1, table S1.1 (A1 to A6) the activities shall, subject to the conditions of this permit, be operated using the techniques and in the manner described in the documentation specified in schedule 1, table S1.2, unless otherwise agreed in writing by the Environment Agency.
- 2.3.2 If notified by the Environment Agency that the activities are giving rise to pollution, the operator shall submit to the Environment Agency for approval within the period specified, a revision of any plan or other documentation (“plan”) specified in schedule 1, table S1.2 or otherwise required under this permit which identifies and minimises the risks of pollution relevant to that plan, and shall implement the approved revised plan in place of the original from the date of approval, unless otherwise agreed in writing by the Environment Agency.
- 2.3.3 Any raw materials or fuels listed in schedule 2, table S2.1 shall conform to the specifications set out in that table.
- 2.3.4 Waste shall only be accepted if:
- (a) it is of a type and quantity listed in schedule 2, tables S2.2 and S2.3; and
  - (b) it conforms to the description in the documentation supplied by the producer and holder.
- 2.3.5 The operator shall ensure that where waste produced by the activities is sent to a relevant waste operation, that operation is provided with the following information, prior to the receipt of the waste:
- (a) the nature of the process producing the waste;
  - (b) the composition of the waste;
  - (c) the handling requirements of the waste;
  - (d) the hazardous property associated with the waste, if applicable; and
  - (e) the waste code of the waste.
- 2.3.6 The operator shall ensure that where waste produced by the activities is sent to a landfill site, it meets the waste acceptance criteria for that landfill.

#### **Hazardous waste storage and treatment**

- 2.3.7 Hazardous waste shall not be mixed, either with a different category of hazardous waste or with other waste, substances or materials, unless it is authorised by schedule 1, table S1.1 and appropriate measures are taken.



## **WEEE storage**

- 2.3.8 The storage (including temporary storage) of WEEE shall be carried out in accordance with the technical requirements of Annex VIII of the WEEE Directive.

## **2.4 Improvement programme**

- 2.4.1 The operator shall complete the improvements specified in schedule 1, table S1.3 by the date specified in that table unless otherwise agreed in writing by the Environment Agency.
- 2.4.2 Except in the case of an improvement which consists only of a submission to the Environment Agency, the operator shall notify the Environment Agency within 14 days of completion of each improvement.

## **2.5 Pre-operational conditions**

- 2.5.1 The activities shall not be brought into operation until the measures specified in schedule 1 table S1.4A have been completed.
- 2.5.2 The operations specified in schedule 1, table S1.4B shall not commence until the measures specified in that table have been completed.

# **3 Emissions and monitoring**

## **3.1 Emissions to water, air or land**

- 3.1.1 There shall be no point source emissions to water, air or land except from the sources and emission points listed in schedule 3, table S3.1 and S3.2.
- 3.1.2 The limits given in schedule 3 shall not be exceeded.
- 3.1.3 Periodic monitoring shall be carried out at least once every 5 years for groundwater and 10 years for soil, unless such monitoring is based on a systematic appraisal of the risk of contamination.

## **3.2 Emissions of substances not controlled by emission limits**

- 3.2.1 Emissions of substances not controlled by emission limits (excluding odour) shall not cause pollution. The operator shall not be taken to have breached this condition if appropriate measures, including, but not limited to, those specified in any approved emissions management plan, have been taken to prevent or where that is not practicable, to minimise, those emissions.
- 3.2.2 The operator shall:
- (a) if notified by the Environment Agency that the activities are giving rise to pollution, submit to the Environment Agency for approval within the period specified, an emissions management plan which identifies and minimises the risks of pollution from emissions of substances not controlled by emission limits;
  - (b) implement the approved emissions management plan, from the date of approval, unless otherwise agreed in writing by the Environment Agency.
- 3.2.3 All liquids in containers, whose emission to water or land could cause pollution, shall be provided with secondary containment, unless the operator has used other appropriate measures to prevent or where that is not practicable, to minimise, leakage and spillage from the primary container.

### **3.3 Odour**

3.3.1 Emissions from the activities shall be free from odour at levels likely to cause pollution outside the site, as perceived by an authorised officer of the Environment Agency, unless the operator has used appropriate measures, including, but not limited to, those specified in any approved odour management plan, to prevent or where that is not practicable to minimise the odour.

3.3.2 The operator shall:

- (a) if notified by the Environment Agency that the activities are giving rise to pollution outside the site due to odour, submit to the Environment Agency for approval within the period specified, an odour management plan which identifies and minimises the risks of pollution from odour;
- (b) implement the approved odour management plan, from the date of approval, unless otherwise agreed in writing by the Environment Agency.

### **3.4 Noise and vibration**

3.4.1 Emissions from the activities shall be free from noise and vibration at levels likely to cause pollution outside the site, as perceived by an authorised officer of the Environment Agency, unless the operator has used appropriate measures, including, but not limited to, those specified in any approved noise and vibration management plan to prevent or where that is not practicable to minimise the noise and vibration.

3.4.2 The operator shall:

- (a) if notified by the Environment Agency that the activities are giving rise to pollution outside the site due to noise and vibration, submit to the Environment Agency for approval within the period specified, a noise and vibration management plan which identifies and minimises the risks of pollution from noise and vibration;
- (b) implement the approved noise and vibration management plan, from the date of approval, unless otherwise agreed in writing by the Environment Agency.

### **3.5 Monitoring**

3.5.1 The operator shall, unless otherwise agreed in writing by the Environment Agency, undertake the monitoring specified in the following tables in schedule 3 to this permit:

- (a) point source emissions specified in tables S3.1 and S3.2.

3.5.2 The operator shall maintain records of all monitoring required by this permit including records of the taking and analysis of samples, instrument measurements (periodic and continual), calibrations, examinations, tests and surveys and any assessment or evaluation made on the basis of such data.

3.5.3 Monitoring equipment, techniques, personnel and organisations employed for the emissions monitoring programme and the environmental or other monitoring specified in condition 3.5.1 shall have either MCERTS certification or MCERTS accreditation (as appropriate), where available, unless otherwise agreed in writing by the Environment Agency.

3.5.4 Permanent means of access shall be provided to enable sampling/monitoring to be carried out in relation to the emission points specified in schedule 3, tables S3.1 and S3.2, unless otherwise agreed in writing by the Environment Agency.

## **3.6 Pests**

- 3.6.1 The activities shall not give rise to the presence of pests which are likely to cause pollution, hazard or annoyance outside the boundary of the site. The operator shall not be taken to have breached this condition if appropriate measures, including, but not limited to, those specified in any approved pests management plan, have been taken to prevent or where that is not practicable, to minimise the presence of pests on the site.
- 3.6.2 The operator shall:
- (a) if notified by the Environment Agency, submit to the Environment Agency for approval within the period specified, a pests management plan which identifies and minimises risks of pollution from pests;
  - (b) implement the pests management plan, from the date of approval, unless otherwise agreed in writing by the Environment Agency.

## **3.7 Fire prevention**

- 3.7.1 The operator shall take all appropriate measures to prevent fires on site and minimise the risk of pollution from them including, but not limited to, those specified in any approved fire prevention plan.

# **4 Information**

## **4.1 Records**

- 4.1.1 All records required to be made by this permit shall:
- (a) be legible;
  - (b) be made as soon as reasonably practicable;
  - (c) if amended, be amended in such a way that the original and any subsequent amendments remain legible, or are capable of retrieval; and
  - (d) be retained, unless otherwise agreed in writing by the Environment Agency, for at least 6 years from the date when the records were made, or in the case of the following records until permit surrender:
    - (i) off-site environmental effects; and
    - (ii) matters which affect the condition of the land and groundwater.
- 4.1.2 The operator shall keep on site all records, plans and the management system required to be maintained by this permit, unless otherwise agreed in writing by the Environment Agency.

## **4.2 Reporting**

- 4.2.1 The operator shall send all reports and notifications required by the permit to the Environment Agency using the contact details supplied in writing by the Environment Agency.

- 4.2.2 For the following activities referenced in schedule 1, table S1.1 (A1 to A6) a report or reports on the performance of the activities over the previous year shall be submitted to the Environment Agency by 31 January (or other date agreed in writing by the Environment Agency) each year. The report(s) shall include as a minimum:
- (a) a review of the results of the monitoring and assessment carried out in accordance with the permit including an interpretive review of that data;
  - (b) the performance parameters set out in schedule 4, table S4.1 using the forms specified in table S4.2 of that schedule.
- 4.2.3 Within 28 days of the end of the reporting period the operator shall, unless otherwise agreed in writing by the Environment Agency, submit reports of the monitoring and assessment carried out in accordance with the conditions of this permit, as follows:
- (a) for the reporting periods specified in schedule 4, table S4.1 and using the forms specified in schedule 4, table S4.2; and
  - (b) giving the information from such results and assessments as may be required by the forms specified in those tables.
- 4.2.4 The operator shall, unless notice under this condition has been served within the preceding four years, submit to the Environment Agency, within six months of receipt of a written notice, a report assessing whether there are other appropriate measures that could be taken to prevent, or where that is not practicable, to minimise pollution.
- 4.2.5 Within 1 month of the end of each quarter, the operator shall submit to the Environment Agency using the form made available for the purpose, the information specified on the form relating to the site and the waste accepted and removed from it during the previous quarter.

### **4.3 Notifications**

- 4.3.1 In the event:
- (a) that the operation of the activities gives rise to an incident or accident which significantly affects or may significantly affect the environment, the operator must immediately—
    - (i) inform the Environment Agency,
    - (ii) take the measures necessary to limit the environmental consequences of such an incident or accident, and
    - (iii) take the measures necessary to prevent further possible incidents or accidents;
  - (b) of a breach of any permit condition the operator must immediately—
    - (i) inform the Environment Agency, and
    - (ii) take the measures necessary to ensure that compliance is restored within the shortest possible time;
  - (c) of a breach of permit condition which poses an immediate danger to human health or threatens to cause an immediate significant adverse effect on the environment, the operator must immediately suspend the operation of the activities or the relevant part of it until compliance with the permit conditions has been restored.
- 4.3.2 Any information provided under condition 4.3.1 (a)(i), or 4.3.1 (b)(i) where the information relates to the breach of a limit specified in the permit, shall be confirmed by sending the information listed in schedule 5 to this permit within the time period specified in that schedule.

- 4.3.3 Where the Environment Agency has requested in writing that it shall be notified when the operator is to undertake monitoring and/or spot sampling, the operator shall inform the Environment Agency when the relevant monitoring and/or spot sampling is to take place. The operator shall provide this information to the Environment Agency at least 14 days before the date the monitoring is to be undertaken.
- 4.3.4 The Environment Agency shall be notified within 14 days of the occurrence of the following matters, except where such disclosure is prohibited by Stock Exchange rules:
- Where the operator is a registered company:
- (a) any change in the operator's trading name, registered name or registered office address; and
  - (b) any steps taken with a view to the operator going into administration, entering into a company voluntary arrangement or being wound up.
- Where the operator is a corporate body other than a registered company:
- (a) any change in the operator's name or address; and
  - (b) any steps taken with a view to the dissolution of the operator.
- In any other case:
- (a) the death of any of the named operators (where the operator consists of more than one named individual);
  - (b) any change in the operator's name(s) or address(es); and
  - (c) any steps taken with a view to the operator, or any one of them, going into bankruptcy, entering into a composition or arrangement with creditors, or, in the case of them being in a partnership, dissolving the partnership.
- 4.3.5 Where the operator proposes to make a change in the nature or functioning, or an extension of the activities, which may have consequences for the environment and the change is not otherwise the subject of an application for approval under the Regulations or this permit:
- (a) the Environment Agency shall be notified at least 14 days before making the change; and
  - (b) the notification shall contain a description of the proposed change in operation.
- 4.3.6 The Environment Agency shall be given at least 14 days notice before implementation of any part of the site closure plan.
- 4.3.7 Where the operator has entered into a climate change agreement with the Government, the Environment Agency shall be notified within one month of:
- (a) a decision by the Secretary of State not to re-certify the agreement;
  - (b) a decision by either the operator or the Secretary of State to terminate the agreement; and
  - (c) any subsequent decision by the Secretary of State to re-certify such an agreement.

## 4.4 Interpretation

- 4.4.1 In this permit the expressions listed in schedule 6 shall have the meaning given in that schedule.
- 4.4.2 In this permit references to reports and notifications mean written reports and notifications, except where reference is made to notification being made "immediately", in which case it may be provided by telephone.

# Schedule 1 – Operations

<b>Table S1.1 activities</b>			
<b>Activity reference</b>	<b>Activity listed in Schedule 1 of the EP Regulations</b>	<b>Description of specified activity and WFD Annex I and II operations</b>	<b>Limits of specified activity and waste types</b>
A1	Section 5.6 Part A(1)(a) Temporary storage of hazardous waste with a total capacity exceeding 50 tonnes.	D15/R13 storage pending treatment on site or transfer off site.	Including storage of wastes from treatment activities.  Hazardous wastes types as specified in Schedule 2 table S2.2.
A2	Section 5.3 Part A(1)(a) Disposal or recovery of hazardous waste with capacity exceeding 10 tonnes per day involving one or more of the following activities:	(iv) repackaging prior to submission to any of the other activities listed in Section 5.3 or in Section 5.1.  D14/R3/R4/R5 repackaging and bulking of wastes.	Hazardous waste types as specified in Schedule 2 table S2.2.
A3		(ii) physico-chemical treatment.  D9 phase separation and filtration of waste.	Phase separation and filtration of waste. Maximum throughput 200 tonnes/day.  Waste types as specified in Schedule 2 table S2.3.
A4	Section 5.4 Part A(1)(a) Disposal of non-hazardous waste with a capacity exceeding 50 tonnes per day involving one or more of the following activities:	(ii) physico-chemical treatment.  D9 phase separation and filtration of waste.	Phase separation and filtration of waste. Maximum throughput 200 tonnes/day.  Waste types as specified in Schedule 2 table S2.3.
<b>Directly Associated Activity</b>			
A5	Storage of non-hazardous waste.	D15/R13 Storage pending treatment on-site and post treatment.	Including: Storage of wastes pre and post treatment.  Non-hazardous waste types as specified in Schedule 2 table S2.3.
A6	Vehicle washing.	Washing of vehicles and tankers.	Washing of vehicles and tanker barrels and on-site treatment of resulting effluent.  Washing out of tanker barrels limited to those containing wastes residues suitable for on-site treatment as specified in Schedule 2 table S2.3.

<b>Table S1.1 activities</b>		
	<b>Description of activities for waste operations</b>	<b>Limits of activities</b>
A7	D15 Storage pending any of the operations numbered D1 to D14. R13 Storage of waste pending any of the operations numbered R1 to R12.	Storage of non-hazardous wastes.  All waste must be kept within a secure container. All waste must be kept on an impermeable surface with sealed drainage.  Non-hazardous waste types as specified in Schedule 2 table S2.2.
A8	D14 Repackaging prior to submission to any of the operations numbered D1 to D13. R3 Recycling/reclamation of organic substances which are not used as solvents. R4: Recycling/reclamation of metals and metal compounds. R5: Recycling/reclamation of other inorganic materials.	Repackaging of non-hazardous wastes.  All repackaging and bulking must be carried out inside a building.  Non-hazardous waste types as specified in Schedule 2 table S2.2.

<b>Table S1.2 Operating techniques</b>		
<b>Description</b>	<b>Parts</b>	<b>Date Received</b>
Application EPR/YP3832WS/A001	Responses to answers provided in Parts B2, B3 and B4 of the application form and associated documents.  Excluding: OATESB304A: Waste Pre-acceptance OATESB304B: Waste Acceptance OATESB306: Summary of Treatment Activities	Duly Made 28/09/2015
Response to Schedule 5 Notice dated 05/11/2015	Response to questions 1-7, 9-14, 17, 25 Response to questions 8, 15, 16, 18-24.  Excluding: RD39: Appendix XXXV Fire Risk Assessment RD40: Auto Extinguishers RD42: Site Maps (FPP) RD43: Waste Flowcharts RD44: Infrastructure Site Plan 1 RD45: Installation Infrastructure 11	23/11/2015  09/12/2015
Variation application EPR/YP3832WS/V002	Responses to answers provided in Parts C0.5 of the application form and associated documents.	Duly Made 26/05/2016
Further information requested 01/06/2016	Response including revised versions of the following documents: RD10: Method statement bulk storage liquid RD30: OATESB304B Waste acceptance RD31: OATESB306 Summary of treatment activities RD37: Tanker washout	06/06/2016

<b>Table S1.2 Operating techniques</b>		
<b>Description</b>	<b>Parts</b>	<b>Date Received</b>
Variation application EPR/YP3832WS/V004	14.3 Storage of Packaged Waste on Site 18 Emergency Preparedness and Response	12/06/2020
	Risk Assessment – Storage of waste outside the building – Control Measures only	
	Approved Fire Prevention Plan consisting of the following: - Fire Prevention Plan (OatesFPP05), dated June 2020 - Appendix 5 – concrete wall specs - Appendix 7 Auto Extinguishers - Site layout plan – Appendix 25 Site ref. INSTALLATION INFRASTRUCTURE 19, dated 29/10/2019.	02/07/2020
	- Risk Assessment – Firewater containment.- Control measures only	06/07/2020
Response to request for information dated 31/07/2020	Holding area and waste bay infrastructure details	03/08/2020
	Further waste bay infrastructure details	04/08/2020

<b>Table S1.3 Improvement programme requirements</b>		
<b>Reference</b>	<b>Requirement</b>	<b>Date</b>
IC1	The operator shall submit a written report to the Environment Agency for approval. The report shall contain the results of a review of the actual UF plant permeate quality against the expected effluent quality supplied as part of the application. If the actual UF plant permeate data exceeds the worst case, the report shall include an assessment of the impact using our H1 methodology (or equivalent method).  The notification requirements of condition 2.4.2 will be deemed to have been complied with on submission of the report.	Completed 14/07/20

<b>Table S1.4A Pre-operational measures</b>	
<b>Reference</b>	<b>Pre-operational measures</b>
1	The operator shall submit a written report to the Environment Agency demonstrating that all bulk liquid storage tanks, pipelines and secondary containment have been leak-tested at least 4 weeks before the start of operations.  Completed 22/10/16.



<b>Table S1.4B Pre-operational measures for future development</b>		
<b>Reference</b>	<b>Operation</b>	<b>Pre-operational measures</b>
1	Discharge of effluent to sewer.	No discharge of any trade effluent to sewer shall be made until the operator has provided a copy of a valid Trade Effluent Discharge Consent for the discharge to the Environment Agency. Completed 14/12/16.
2	Storage of waste authorised under Activities A1 and A7 of Table S1.1.	There shall be no storage of waste outside of the building until the operator has provided a report, to the Environment Agency for approval, which demonstrates the infrastructure as agreed in table S1.2 Operating Techniques has been installed in the rear yard as shown on the site layout plan in schedule 7. Storage of waste outside may commence once written agreement has been obtained from the Environment Agency.

## Schedule 2 – Waste types, raw materials and fuels

Raw materials and fuel description	Specification
--	--

<b>Maximum quantity</b>	Non-hazardous waste storage: maximum of 670 tonnes. Hazardous waste storage: maximum of 670 tonnes. Maximum storage duration: 3 months. Notwithstanding the listed wastes below, wastes with the following Hazardous Properties are not permitted: HP1, HP9, HP15.
<b>Waste code</b>	<b>Description</b>
<b>01</b>	<b>WASTES RESULTING FROM EXPLORATION, MINING, QUARRYING, AND PHYSICAL AND CHEMICAL TREATMENT OF MINERALS</b>
<b>01 01</b>	<b>wastes from mineral excavation</b>
01 01 01	wastes from mineral metalliferous excavation
01 01 02	wastes from mineral non-metalliferous excavation
<b>01 03</b>	<b>wastes from physical and chemical processing of metalliferous minerals</b>
01 03 08	dusty and powdery wastes other than those mentioned in 01 03 07
<b>01 04</b>	<b>wastes from physical and chemical processing of non-metalliferous minerals</b>
01 04 07*	wastes containing hazardous substances from physical and chemical processing of non-metalliferous minerals
01 04 09	waste sand and clays
01 04 13	wastes from stone cutting and sawing other than those mentioned in 01 04 07
<b>01 05</b>	<b>drilling muds and other drilling wastes</b>
01 05 04	freshwater drilling muds and wastes
01 05 05*	oil-containing drilling muds and wastes
01 05 06*	drilling muds and other drilling wastes containing hazardous substances
<b>02</b>	<b>WASTES FROM AGRICULTURE, HORTICULTURE, AQUACULTURE, FORESTRY, HUNTING AND FISHING, FOOD PREPARATION AND PROCESSING</b>
<b>02 01</b>	<b>wastes from agriculture, horticulture, aquaculture, forestry, hunting and fishing</b>
02 01 01	sludges from washing and cleaning
02 01 08*	agrochemical waste containing hazardous substances
02 01 09	agrochemical waste other than those mentioned in 02 01 08
<b>02 02</b>	<b>wastes from the preparation and processing of meat, fish and other foods of animal origin</b>
02 02 01	sludges from washing and cleaning
02 02 04	sludges from on-site effluent treatment
<b>02 03</b>	<b>wastes from fruit, vegetables, cereals, edible oils, cocoa, coffee, tea and tobacco preparation and processing; conserve production; yeast and yeast extract production, molasses preparation and fermentation</b>

<b>Table S2.2 Permitted waste types and quantities for storage</b>	
<b>Maximum quantity</b>	Non-hazardous waste storage: maximum of 670 tonnes. Hazardous waste storage: maximum of 670 tonnes. Maximum storage duration: 3 months. Notwithstanding the listed wastes below, wastes with the following Hazardous Properties are not permitted: HP1, HP9, HP15.
<b>Waste code</b>	<b>Description</b>
02 03 01	sludges from washing, cleaning, peeling, centrifuging and separation
02 03 02	wastes from preserving agents
02 03 04	materials unsuitable for consumption or processing
02 03 05	sludges from on-site effluent treatment
<b>02 04</b>	<b>wastes from sugar processing</b>
02 04 02	off-specification calcium carbonate
02 04 03	sludges from on-site effluent treatment
<b>02 05</b>	<b>wastes from the dairy products industry</b>
02 05 01	materials unsuitable for consumption or processing
02 05 02	sludges from on-site effluent treatment
<b>02 06</b>	<b>wastes from the baking and confectionery industry</b>
02 06 01	materials unsuitable for consumption or processing
02 06 02	wastes from preserving agents
02 06 03	sludges from on-site effluent treatment
<b>02 07</b>	<b>wastes from the production of alcoholic and non-alcoholic beverages (except coffee, tea and cocoa)</b>
02 07 01	wastes from washing, cleaning and mechanical reduction of raw materials
02 07 04	materials unsuitable for consumption or processing
02 07 05	sludges from on-site effluent treatment
<b>03</b>	<b>WASTES FROM WOOD PROCESSING AND THE PRODUCTION OF PANELS AND FURNITURE, PULP, PAPER AND CARDBOARD</b>
<b>03 01</b>	<b>wastes from wood processing and the production of panels and furniture</b>
03 01 04*	sawdust, shavings, cuttings, wood, particle board and veneer containing hazardous substances
03 01 05	sawdust, shavings, cuttings, wood, particle board and veneer other than those mentioned in 03 01 04
<b>03 02</b>	<b>wastes from wood preservation</b>
03 02 01*	non-halogenated organic wood preservatives
03 02 02*	organochlorinated wood preservatives
03 02 03*	organometallic wood preservatives
03 02 04*	inorganic wood preservatives
03 02 05*	other wood preservatives containing hazardous substances
<b>03 03</b>	<b>wastes from pulp, paper and cardboard production and processing</b>
03 03 05	de-inking sludges from paper recycling
03 03 07	mechanically separated rejects from pulping of waste paper and cardboard

<b>Table S2.2 Permitted waste types and quantities for storage</b>	
<b>Maximum quantity</b>	Non-hazardous waste storage: maximum of 670 tonnes. Hazardous waste storage: maximum of 670 tonnes. Maximum storage duration: 3 months. Notwithstanding the listed wastes below, wastes with the following Hazardous Properties are not permitted: HP1, HP9, HP15.
<b>Waste code</b>	<b>Description</b>
03 03 08	wastes from sorting of paper and cardboard destined for recycling lime mud waste
03 03 11	sludges from on-site effluent treatment other than those mentioned in 03 03 10
<b>04</b>	<b>WASTES FROM THE LEATHER, FUR AND TEXTILE INDUSTRIES</b>
<b>04 01</b>	<b>wastes from the leather and fur industry</b>
04 01 03*	degreasing wastes containing solvents without a liquid phase
04 01 09	wastes from dressing and finishing
<b>04 02</b>	<b>wastes from the textile industry</b>
04 02 10	organic matter from natural products (for example grease, wax)
04 02 14*	wastes from finishing containing organic solvents
04 02 15	wastes from finishing other than those mentioned in 04 02 14
04 02 16*	dyestuffs and pigments containing hazardous substances
04 02 17	dyestuffs and pigments other than those mentioned in 04 02 16
04 02 19*	sludges from on-site effluent treatment containing hazardous substances
04 02 20	sludges from on-site effluent treatment other than those mentioned in 04 02 19
04 02 21	wastes from unprocessed textile fibres
04 02 22	wastes from processed textile fibres
<b>05</b>	<b>WASTES FROM PETROLEUM REFINING, NATURAL GAS PURIFICATION AND PYROLYTIC TREATMENT OF COAL</b>
<b>05 01</b>	<b>wastes from petroleum refining</b>
05 01 03*	tank bottom sludges
05 01 04*	acid alkyl sludges
05 01 05*	oil spills
05 01 06*	oily sludges from maintenance operations of the plant or equipment
05 01 09*	sludges from on-site effluent treatment containing hazardous substances
05 01 10	sludges from on-site effluent treatment other than those mentioned in 05 01 09
05 01 11*	wastes from cleaning of fuels with bases
05 01 12*	oil containing acids
05 01 17	bitumen
<b>05 06</b>	<b>wastes from the pyrolytic treatment of coal</b>
05 06 01*	acid tars
05 06 03*	other tars
<b>05 07</b>	<b>wastes from the natural gas purification and transportation</b>
05 07 01*	wastes containing mercury
05 07 02	wastes containing sulphur

<b>Table S2.2 Permitted waste types and quantities for storage</b>	
<b>Maximum quantity</b>	Non-hazardous waste storage: maximum of 670 tonnes. Hazardous waste storage: maximum of 670 tonnes. Maximum storage duration: 3 months. Notwithstanding the listed wastes below, wastes with the following Hazardous Properties are not permitted: HP1, HP9, HP15.
<b>Waste code</b>	<b>Description</b>
<b>06</b>	<b>WASTES FROM INORGANIC CHEMICAL PROCESSES</b>
<b>06 01</b>	<b>wastes from the manufacture, formulation, supply and use (MFSU) of acids</b>
06 01 01*	sulphuric acid and sulphurous acid
06 01 02*	hydrochloric acid
06 01 03*	hydrofluoric acid
06 01 04*	phosphoric and phosphorous acid
06 01 05*	nitric acid and nitrous acid
06 01 06*	other acids
<b>06 02</b>	<b>wastes from the MFSU of bases</b>
06 02 01*	calcium hydroxide
06 02 03*	ammonium hydroxide
06 02 04*	sodium and potassium hydroxide
06 02 05*	other bases
<b>06 04</b>	<b>metal-containing wastes other than those mentioned in 06 03</b>
06 04 03*	wastes containing arsenic
06 04 04*	wastes containing mercury
06 04 05*	wastes containing other heavy metals
<b>06</b>	<b>WASTES FROM INORGANIC CHEMICAL PROCESSES</b>
<b>06 05</b>	<b>sludges from on-site effluent treatment</b>
06 05 02*	sludges from on-site effluent treatment containing hazardous substances
06 05 03	sludges from on-site effluent treatment other than those mentioned in 06 05 02
<b>06 06</b>	<b>wastes from the MFSU of sulphur chemicals, sulphur chemical processes and desulphurisation processes</b>
06 06 02*	wastes containing hazardous sulphides
06 06 03	wastes containing sulphides other than those mentioned in 06 06 02
<b>06 08</b>	<b>wastes from the MFSU of silicon and silicon derivatives</b>
06 08 02*	wastes containing hazardous chlorosilanes
<b>06 09</b>	<b>wastes from the MFSU of phosphorous chemicals and phosphorous chemical processes</b>
06 09 03*	calcium-based reaction wastes containing or contaminated with hazardous substances
06 09 04	calcium-based reaction wastes other than those mentioned in 06 09 03
<b>06 10</b>	<b>wastes from the MFSU of nitrogen chemicals, nitrogen chemical processes and fertiliser manufacture</b>
06 10 02*	wastes containing hazardous substances
<b>06 13</b>	<b>wastes from inorganic chemical processes not otherwise specified</b>

<b>Table S2.2 Permitted waste types and quantities for storage</b>	
<b>Maximum quantity</b>	Non-hazardous waste storage: maximum of 670 tonnes. Hazardous waste storage: maximum of 670 tonnes. Maximum storage duration: 3 months. Notwithstanding the listed wastes below, wastes with the following Hazardous Properties are not permitted: HP1, HP9, HP15.
<b>Waste code</b>	<b>Description</b>
06 13 01*	inorganic plant protection products, wood-preserving agents and other biocides.
06 13 02*	spent activated carbon (except 06 07 02)
06 13 05*	soot
<b>07</b>	<b>WASTES FROM ORGANIC CHEMICAL PROCESSES</b>
<b>07 01</b>	<b>wastes from the manufacture, formulation, supply and use (MFSU) of basic organic chemicals</b>
07 01 01*	aqueous washing liquids and mother liquors
07 01 03*	organic halogenated solvents, washings liquids and mother liquors
07 01 04*	other organic solvents, washing liquids and mother liquors
07 01 07*	halogenated still bottoms and reaction residues
07 01 08*	other still bottoms and reaction residues
07 01 09*	halogenated filter cakes and spent absorbents
07 01 10*	other filter cakes and spent absorbents
07 01 11*	sludges from on-site effluent treatment containing hazardous substances
07 01 12	sludges from on-site effluent treatment other than those mentioned in 07 01 11
<b>07 02</b>	<b>wastes from the MFSU of plastics, synthetic rubber and man-made fibres</b>
07 02 01*	aqueous washing liquids and mother liquors
07 02 03*	organic halogenated solvents, washing and mother liquors
07 02 04*	other organic solvents, washing liquids and mother liquors
07 02 07*	halogenated still bottoms and reaction residues
07 02 08*	other still bottoms and reaction residues
07 02 09*	halogenated filter cakes and spent absorbents
07 02 10*	other filter cakes and spent absorbents
07 02 11*	sludges from on-site effluent treatment containing hazardous substances
07 02 12	sludges from on-site effluent treatment other than those mentioned in 07 02 11
07 02 13	waste plastic
07 02 14*	wastes from additives containing hazardous substances
07 02 15	wastes from additives other than those mentioned in 07 02 14
07 02 16*	wastes containing hazardous silicones
07 02 17	wastes containing silicones other than those mentioned in 07 02 16
<b>07 03</b>	<b>wastes from the MFSU of organic dyes and pigments (except 06 11)</b>
07 03 01*	aqueous washing liquids and mother liquors
07 03 03*	organic halogenated solvents, washing liquids and mother liquors
07 03 04*	other organic solvents, washing liquids and mother liquors

<b>Table S2.2 Permitted waste types and quantities for storage</b>	
<b>Maximum quantity</b>	Non-hazardous waste storage: maximum of 670 tonnes. Hazardous waste storage: maximum of 670 tonnes. Maximum storage duration: 3 months. Notwithstanding the listed wastes below, wastes with the following Hazardous Properties are not permitted: HP1, HP9, HP15.
<b>Waste code</b>	<b>Description</b>
07 03 07*	halogenated still bottoms and reaction residues
07 03 08*	other still bottoms and reaction residues
07 03 09*	halogenated filter cakes and spent absorbents
07 03 10*	other filter cakes and spent absorbents
07 03 11*	sludges from on-site effluent treatment containing hazardous substances
07 03 12	sludges from on-site effluent treatment other than those mentioned in 07 03 11
<b>07 04</b>	<b>wastes from the MFSU of organic plant protection products (except 02 01 08 and 02 01 09), wood preserving agents (except 03 02) and other biocides</b>
07 04 01*	aqueous washing liquids and mother liquors
07 04 03*	organic halogenated solvents, washing liquids and mother liquors
07 04 04*	other organic solvents, washing liquids and mother liquors
07 04 07*	halogenated still bottoms and reaction residues
07 04 08*	other still bottoms and reaction residues
07 04 09*	halogenated filter cakes and spent absorbents
07 04 10*	other filter cakes and spent absorbents
07 04 11*	sludges from on-site effluent treatment containing hazardous substances
07 04 12	sludges from on-site effluent treatment other than those mentioned in 07 04 11
07 04 13*	solid wastes containing hazardous substances
<b>07 05</b>	<b>wastes from the MFSU of pharmaceuticals</b>
07 05 01*	aqueous washing liquids and mother liquors
07 05 03*	organic halogenated solvents, washing liquids and mother liquors
07 05 04*	other organic solvents, washing liquids and mother liquors
07 05 07*	halogenated still bottoms and reaction residues
07 05 08*	other still bottoms and reaction residues
07 05 09*	halogenated filter cakes and spent absorbents
07 05 10*	other filter cakes and spent absorbents
07 05 11*	sludges from on-site effluent treatment containing hazardous substances
07 05 12	sludges from on-site effluent treatment other than those mentioned in 07 05 11
07 05 13*	solid wastes containing hazardous substances
07 05 14	solid wastes other than those mentioned in 07 05 13
<b>07 06</b>	<b>wastes from the MFSU of fats, grease, soaps, detergents, disinfectants and cosmetics</b>
07 06 01*	aqueous washing liquids and mother liquors
07 06 03*	organic halogenated solvents, washing liquids and mother liquors
07 06 04*	other organic solvents, washing liquids and mother liquors

<b>Table S2.2 Permitted waste types and quantities for storage</b>	
<b>Maximum quantity</b>	Non-hazardous waste storage: maximum of 670 tonnes. Hazardous waste storage: maximum of 670 tonnes. Maximum storage duration: 3 months. Notwithstanding the listed wastes below, wastes with the following Hazardous Properties are not permitted: HP1, HP9, HP15.
<b>Waste code</b>	<b>Description</b>
07 06 07*	halogenated still bottoms and reaction residues
07 06 08*	other still bottoms and reaction residues
07 06 09*	halogenated still bottoms and spent absorbents
07 06 10*	other filter cakes and spent absorbents
07 06 11*	sludges from on-site effluent treatment containing hazardous substances
07 06 12	sludges from on-site effluent treatment other than those mentioned in 07 06 11
<b>07 07</b>	<b>wastes from the MFSU of fine chemicals and chemical products not otherwise specified</b>
07 07 01*	aqueous washing liquids and mother liquors
07 07 03*	organic halogenated solvents, washing liquids and mother liquors
07 07 04*	other organic solvents, washing liquids and mother liquors
07 07 07*	halogenated still bottoms and reaction residues
07 07 08*	other still bottoms and reaction residues
07 07 09*	halogenated filter cakes and spent absorbents
07 07 10*	other filter cakes and spent absorbents
07 07 11*	sludges from on-site effluent treatment containing hazardous substances
07 07 12	sludges from on-site effluent treatment other than those mentioned in 07 07 11
<b>08</b>	<b>WASTES FROM THE MANUFACTURE, FORMULATION, SUPPLY AND USE (MFSU) OF COATINGS (PAINTS, VARNISHES AND VITREOUS ENAMELS), ADHESIVES, SEALANTS AND PRINTING INKS</b>
<b>08 01</b>	<b>wastes from MFSU and removal of paint and varnish</b>
08 01 11*	waste paint and varnish containing organic solvents or other hazardous substances
08 01 12	waste paint and varnish other than those mentioned in 08 01 11
08 01 13*	sludges from paint or varnish containing organic solvents or other hazardous substances
08 01 14	sludges from paint or varnish other than those mentioned in 08 01 13
08 01 15*	aqueous sludges containing paint or varnish containing organic solvents and other hazardous substances
08 01 16	aqueous sludges containing paint or varnish other than those mentioned in 08 01 15
08 01 17*	wastes from paint or varnish removal containing organic solvents or other hazardous substances
08 01 18	wastes from paint or varnish removal other than those mentioned in 08 01 17
08 01 19*	aqueous suspensions containing paint or varnish containing organic solvents or other hazardous substances
08 01 20	aqueous suspensions containing paint or varnish other than those mentioned in 08 01 19
08 01 21*	waste paint or varnish remover



<b>Table S2.2 Permitted waste types and quantities for storage</b>	
<b>Maximum quantity</b>	Non-hazardous waste storage: maximum of 670 tonnes. Hazardous waste storage: maximum of 670 tonnes. Maximum storage duration: 3 months. Notwithstanding the listed wastes below, wastes with the following Hazardous Properties are not permitted: HP1, HP9, HP15.
<b>Waste code</b>	<b>Description</b>
<b>08 02</b>	<b>wastes from MFSU of other coatings (including ceramic materials)</b>
08 02 01	waste coating powders
08 02 02	aqueous sludges containing ceramic materials
08 02 03	aqueous suspensions containing ceramic materials
<b>08 03</b>	<b>wastes from MFSU of printing inks</b>
08 03 07	aqueous sludges containing ink
08 03 08	aqueous liquid waste containing ink
08 03 12*	waste ink containing hazardous substances
08 03 13	waste ink other than those mentioned in 08 03 12
08 03 14*	ink sludges containing hazardous substances
08 03 15	ink sludges other than those mentioned in 08 03 14
08 03 16*	waste etching solutions
08 03 17*	waste printing toner containing hazardous substances
08 03 18	waste printing toner other than those mentioned in 08 03 17
08 03 19*	disperse oil
<b>08 04</b>	<b>wastes from MFSU of adhesives and sealants (including waterproofing products)</b>
08 04 09*	waste adhesives and sealants containing organic solvents or other hazardous substances
08 04 10	waste adhesives and sealants other than those mentioned in 08 04 09
08 04 11*	adhesive and sealant sludges containing organic solvents or other hazardous substances
08 04 12	adhesive and sealant sludges other than those mentioned in 08 04 11
08 04 13*	aqueous sludges containing adhesives or sealants containing organic solvents or other hazardous substances
08 04 14	aqueous sludges containing adhesives or sealants other than those mentioned in 08 04 13
08 04 15*	aqueous liquid waste containing adhesives or sealants containing organic solvents or other hazardous substances
08 04 16	aqueous liquid waste containing adhesives or sealants other than those mentioned in 08 04 15
<b>08 05</b>	<b>wastes not otherwise specified in 08</b>
08 05 01*	waste isocyanates
<b>09</b>	<b>WASTES FROM THE PHOTOGRAPHIC INDUSTRY</b>
<b>09 01</b>	<b>wastes from the photographic industry</b>
09 01 01*	water-based developer and activator solutions
09 01 02*	water-based offset plate developer solutions

<b>Table S2.2 Permitted waste types and quantities for storage</b>	
<b>Maximum quantity</b>	Non-hazardous waste storage: maximum of 670 tonnes. Hazardous waste storage: maximum of 670 tonnes. Maximum storage duration: 3 months. Notwithstanding the listed wastes below, wastes with the following Hazardous Properties are not permitted: HP1, HP9, HP15.
<b>Waste code</b>	<b>Description</b>
09 01 03*	solvent based developer solutions
09 01 04*	fixer solutions
09 01 05*	bleach solutions and bleach fixer solutions
09 01 06*	wastes containing silver from on-site treatment of photographic wastes
09 01 07	photographic film and paper containing silver or silver compounds
09 01 08	photographic film and paper free of silver or silver compounds
09 01 10	single use cameras without batteries
09 01 11*	single use cameras containing batteries included in 16 06 01, 16 06 02 or 16 06 03
09 01 12	single use cameras containing batteries other than those mentioned in 09 01 11
09 01 13*	aqueous liquid waste from on-site reclamation of silver other than those mentioned in 09 01 06
<b>10</b>	<b>WASTES FROM THERMAL PROCESSES</b>
<b>10 01</b>	<b>wastes from power stations and other combustion plants (except 19)</b>
10 01 01	bottom ash, slag and boiler dust (excluding boiler dust mentioned in 10 01 04)
10 01 04*	oil fly ash and boiler dust
10 01 09*	sulphuric acid
10 01 20*	sludges from on-site effluent treatment containing hazardous substances
10 01 21	sludges from on-site effluent treatment other than those mentioned in 10 01 20
10 01 22*	aqueous sludges from boiler cleansing containing hazardous substances
10 01 23	aqueous sludges from boiler cleansing other than those mentioned in 10 01 22
10 01 26	wastes from cooling-water treatment
<b>10 02</b>	<b>wastes from the iron and steel industry</b>
10 02 11*	wastes from cooling-water treatment containing oil
10 02 12	wastes from cooling-water treatment other than those mentioned in 10 02 11
10 02 13*	sludges and filter cakes from gas treatment containing hazardous substances
10 02 14	sludges and filter cakes from gas treatment other than those mentioned in 10 02 13
10 02 15	other sludges and filter cakes
<b>10 03</b>	<b>wastes from aluminium thermal metallurgy</b>
10 03 25*	sludges and filter cakes from gas treatment containing hazardous substances
10 03 26	sludges and filter cakes from gas treatment other than those mentioned in 10 03 25
10 03 27*	wastes from cooling-water treatment containing oil
10 03 28	wastes from cooling-water treatment other than those mentioned in 10 03 27
<b>10 04</b>	<b>wastes from lead thermal metallurgy</b>
10 04 09	wastes from cooling-water treatment containing oil

<b>Table S2.2 Permitted waste types and quantities for storage</b>	
<b>Maximum quantity</b>	Non-hazardous waste storage: maximum of 670 tonnes. Hazardous waste storage: maximum of 670 tonnes. Maximum storage duration: 3 months. Notwithstanding the listed wastes below, wastes with the following Hazardous Properties are not permitted: HP1, HP9, HP15.
<b>Waste code</b>	<b>Description</b>
10 04 10	wastes from cooling-water treatment other than those mentioned in 10 04 09
<b>10 05</b>	<b>wastes from zinc thermal metallurgy</b>
10 05 08*	wastes from cooling-water treatment containing oil
10 05 09	wastes from cooling-water treatment other than those mentioned in 10 05 08
<b>10 06</b>	<b>wastes from copper thermal metallurgy</b>
10 06 07*	sludges and filter cakes from gas treatment
10 06 09*	wastes from cooling-water treatment containing oil
10 06 10	wastes from cooling-water treatment other than those mentioned in 10 06 09
<b>10 07</b>	<b>wastes from silver, gold and platinum thermal metallurgy</b>
10 07 07*	wastes from cooling-water treatment containing oil
10 07 08	wastes from cooling water treatment other than those mentioned in 10 07 07
<b>10 08</b>	<b>wastes from other non-ferrous thermal metallurgy</b>
10 08 04	particulates and dust
10 08 15*	Flue-gas dust containing hazardous substances
10 08 19*	wastes from cooling-water treatment containing oil
10 08 20	wastes from cooling-water treatment other than those mentioned in 10 08 19
<b>10 09</b>	<b>wastes from casting of ferrous pieces</b>
10 09 05*	casting cores and moulds which have not undergone pouring containing hazardous substances
10 09 06	casting cores and moulds which have not undergone pouring other than those mentioned in 10 09 05
10 09 07*	casting cores and moulds which have undergone pouring containing hazardous substances
10 09 08	casting cores and moulds which have undergone pouring other than those mentioned in 10 09 07
10 09 15*	waste crack-indicating agent containing hazardous substances
10 09 16	waste crack-indicating agent other than those mentioned in 10 09 15
<b>10 10</b>	<b>wastes from casting of non-ferrous pieces</b>
10 10 05*	casting cores and moulds which have not undergone pouring, containing hazardous substances
10 10 06	casting cores and moulds which have not undergone pouring, other than those mentioned in 10 10 05
10 10 07*	casting cores and moulds which have undergone pouring, containing hazardous substances
10 10 08	casting cores and moulds which have undergone pouring, other than those mentioned in 10 10 07
10 10 15*	waste crack-indicating agent containing hazardous substances

<b>Table S2.2 Permitted waste types and quantities for storage</b>	
<b>Maximum quantity</b>	Non-hazardous waste storage: maximum of 670 tonnes. Hazardous waste storage: maximum of 670 tonnes. Maximum storage duration: 3 months. Notwithstanding the listed wastes below, wastes with the following Hazardous Properties are not permitted: HP1, HP9, HP15.
<b>Waste code</b>	<b>Description</b>
10 10 16	waste crack-indicating agent other than those mentioned in 10 10 15
<b>10 11</b>	<b>wastes from manufacture of glass and glass products</b>
10 11 03	waste glass-based fibrous materials
10 11 05	particulates and dust
10 11 11*	waste glass in small particles and glass powder containing heavy metals (for example from cathode ray tubes)
10 11 12	waste glass other than those mentioned in 10 11 11
10 11 13*	glass polishing and grinding sludge containing hazardous substances
10 11 14	glass polishing and grinding sludge other than those mentioned in 10 11 13
10 11 19*	solid wastes from on site effluent treatment containing hazardous substances
10 11 20	solid wastes from on site effluent treatment other than those mentioned in 10 11 19
<b>10 12</b>	<b>wastes from manufacture of ceramic goods, bricks, tiles and construction products</b>
10 12 06	discarded moulds
10 12 08	waste ceramics, bricks, tiles and construction products (after thermal processing)
10 12 09*	solid wastes from gas treatment containing hazardous substances
10 12 10	solid wastes from gas treatment other than those mentioned in 10 12 09
10 12 11*	wastes from glazing containing heavy metals
10 12 12	wastes from glazing other than those mentioned in 10 12 11
10 12 13	wastes from on-site effluent treatment
<b>10 13</b>	<b>wastes from manufacture of cement, lime and plaster and articles and products made from them</b>
10 13 01	waste preparation mixture before thermal processing
10 13 04	wastes from calcination and hydration of lime
10 13 14	waste concrete and concrete sludge
<b>11</b>	<b>WASTES FROM CHEMICAL SURFACE TREATMENT AND COATING OF METALS AND OTHER MATERIALS; NON-FERROUS HYDRO-METALLURGY</b>
<b>11 01</b>	<b>Wastes from chemical surface treatment and coating of metals and other materials (for example galvanic processes, zinc coating processes, pickling processes, etching, phosphating, alkaline degreasing, anodising)</b>
11 01 05*	pickling acids
11 01 06*	acids not otherwise specified
11 01 07*	pickling bases
11 01 08*	phosphatising sludges
11 01 09*	sludges and filter cakes containing hazardous substances
11 01 10	sludges and filter cakes other than those mentioned in 11 01 09

<b>Table S2.2 Permitted waste types and quantities for storage</b>	
<b>Maximum quantity</b>	Non-hazardous waste storage: maximum of 670 tonnes. Hazardous waste storage: maximum of 670 tonnes. Maximum storage duration: 3 months. Notwithstanding the listed wastes below, wastes with the following Hazardous Properties are not permitted: HP1, HP9, HP15.
<b>Waste code</b>	<b>Description</b>
11 01 11*	aqueous rinsing liquids containing hazardous substances
11 01 12	aqueous rinsing liquids other than those mentioned in 11 01 11
11 01 13*	degreasing wastes containing hazardous substances
11 01 14	degreasing wastes other than those mentioned in 11 01 12
<b>11 02</b>	<b>wastes from non-ferrous hydrometallurgical processes</b>
11 02 07*	other wastes containing hazardous substances
<b>11 05</b>	<b>wastes from hot galvanising processes</b>
11 05 04*	spent flux
<b>12</b>	<b>WASTES FROM SHAPING AND PHYSICAL AND MECHANICAL SURFACE TREATMENT OF METALS AND PLASTICS</b>
<b>12 01</b>	<b>wastes from shaping and physical and mechanical surface treatment of metals and plastics</b>
12 01 01	ferrous metal filings and turnings
12 01 02	ferrous metal dust and particles
12 01 03	non-ferrous metal filings and turnings
12 01 04	non-ferrous metal dust and particles
12 01 05	plastics shavings and turnings
12 01 06*	mineral-based machining oils containing halogens (except emulsions and solutions)
12 01 07*	mineral-based machining oils free of halogens (except emulsions and solutions)
12 01 08*	machining emulsions and solutions containing halogens
12 01 09*	machining emulsions and solutions free of halogens
12 01 10*	synthetic machining oils
12 01 13	welding wastes
12 01 14*	machining sludges containing hazardous substances
12 01 15	machining sludges other than those mentioned in 12 01 14
12 01 16*	waste blasting material containing hazardous substances
12 01 17	waste blasting material other than those mentioned in 12 01 16
12 01 18*	metal sludge (grinding, honing and lapping sludge) containing oil
12 01 19*	readily biodegradable machining oil
12 01 20*	spent grinding bodies and grinding materials containing hazardous substances
12 01 21	spent grinding bodies and grinding materials other than those mentioned in 12 01 20
<b>12 03</b>	<b>wastes from water and steam degreasing processes (except 11)</b>
12 03 01*	aqueous washing liquids
12 03 02*	steam degreasing wastes

<b>Table S2.2 Permitted waste types and quantities for storage</b>	
<b>Maximum quantity</b>	<p>Non-hazardous waste storage: maximum of 670 tonnes.</p> <p>Hazardous waste storage: maximum of 670 tonnes.</p> <p>Maximum storage duration: 3 months.</p> <p>Notwithstanding the listed wastes below, wastes with the following Hazardous Properties are not permitted: HP1, HP9, HP15.</p>
<b>Waste code</b>	<b>Description</b>
<b>13</b>	<b>OIL WASTES AND WASTES OF LIQUID FUELS (except edible oils, and those in chapters 05, 12 and 19)</b>
<b>13 01</b>	<b>waste hydraulic oils</b>
13 01 04*	chlorinated emulsions
13 01 05*	non-chlorinated emulsions
13 01 09*	mineral-based chlorinated hydraulic oils
13 01 10*	mineral based non-chlorinated hydraulic oils
13 01 11*	synthetic hydraulic oils
13 01 12*	readily biodegradable hydraulic oils
13 01 13*	other hydraulic oils
<b>13 02</b>	<b>waste engine, gear and lubricating oils</b>
13 02 04*	mineral-based chlorinated engine, gear and lubricating oils
13 02 05*	mineral-based non-chlorinated engine, gear and lubricating oils
13 02 06*	synthetic engine, gear and lubricating oils
13 02 07*	readily biodegradable engine, gear and lubricating oils
13 02 08*	other engine, gear and lubricating oils
<b>13 03</b>	<b>waste insulating and heat transmission oils</b>
13 03 01*	insulating or heat transmission oils containing PCBs
13 03 06*	mineral-based chlorinated insulating and heat transmission oils other than those mentioned in 13 03 01
13 03 07*	mineral-based non-chlorinated insulating and heat transmission oils
13 03 08*	synthetic insulating and heat transmission oils
13 03 09*	readily biodegradable insulating and heat transmission oils
13 03 10*	other insulating and heat transmission oils
<b>13 04</b>	<b>bilge oils</b>
13 04 01*	bilge oils from inland navigation
13 04 02*	bilge oils from jetty sewers
13 04 03*	bilge oils from other navigation
<b>13 05</b>	<b>oil/water separator contents</b>
13 05 01*	solids from grit chambers and oil/water separators
13 05 02*	sludges from oil/water separators
13 05 03*	interceptor sludges
13 05 06*	oil from oil/water separators
13 05 07*	oily water from oil/water separators
13 05 08*	mixtures of wastes from grit chambers and oil/water separators

<b>Table S2.2 Permitted waste types and quantities for storage</b>	
<b>Maximum quantity</b>	Non-hazardous waste storage: maximum of 670 tonnes. Hazardous waste storage: maximum of 670 tonnes. Maximum storage duration: 3 months. Notwithstanding the listed wastes below, wastes with the following Hazardous Properties are not permitted: HP1, HP9, HP15.
<b>Waste code</b>	<b>Description</b>
<b>13 07</b>	<b>wastes of liquid fuels</b>
13 07 01*	fuel oil and diesel
13 07 03*	other fuels (including mixtures)
<b>13 08</b>	<b>oil wastes not otherwise specified</b>
13 08 01*	desalter sludges or emulsions
13 08 02*	other emulsions
<b>14</b>	<b>WASTE ORGANIC SOLVENTS, REFRIGERANTS AND PROPELLANTS (except 07 and 08)</b>
<b>14 06</b>	<b>waste organic solvents, refrigerants and foam/aerosol propellants</b>
14 06 01*	chlorofluorocarbons, HCFC, HFC
14 06 02*	other halogenated solvents and solvent mixtures
14 06 03*	other solvents and solvent mixtures
14 06 04*	sludges or solid wastes containing halogenated solvents
14 06 05*	sludges or solid wastes containing other solvents
<b>15</b>	<b>WASTE PACKAGING; ABSORBENTS, WIPING CLOTHS, FILTER MATERIALS AND PROTECTIVE CLOTHING NOT OTHERWISE SPECIFIED</b>
<b>15 01</b>	<b>packaging (including separately collected municipal packaging waste)</b>
15 01 01	paper and cardboard packaging
15 01 02	plastic packaging
15 01 03	wooden packaging
15 01 04	metallic packaging
15 01 05	composite packaging
15 01 06	mixed packaging
15 01 07	glass packaging
15 01 09	textile packaging
15 01 10*	packaging containing residues of or contaminated by hazardous substances
15 01 11*	metallic packaging containing a hazardous solid porous matrix (for example asbestos), including empty pressure containers
<b>15 02</b>	<b>absorbents, filter materials, wiping cloths and protective clothing</b>
15 02 02*	absorbents, filter materials (including oil filters not otherwise specified), wiping cloths, protective clothing contaminated by hazardous substances
15 02 03	absorbents, filter materials, wiping cloths and protective clothing other than those mentioned in 15 02 02
<b>16</b>	<b>WASTES NOT OTHERWISE SPECIFIED IN THE LIST</b>

<b>Table S2.2 Permitted waste types and quantities for storage</b>	
<b>Maximum quantity</b>	Non-hazardous waste storage: maximum of 670 tonnes. Hazardous waste storage: maximum of 670 tonnes. Maximum storage duration: 3 months. Notwithstanding the listed wastes below, wastes with the following Hazardous Properties are not permitted: HP1, HP9, HP15.
<b>Waste code</b>	<b>Description</b>
<b>16 01</b>	<b>end-of-life vehicles from different means of transport (including off-road machinery) and wastes from dismantling of end-of-life vehicles and vehicle maintenance (except 13, 14, 16 06 and 16 08)</b>
16 01 03	end-of-life tyres
16 01 07*	oil filters
16 01 11*	brake pads containing asbestos
16 01 12	brake pads other than those mentioned in 16 01 11
16 01 13*	brake fluids
16 01 14*	antifreeze fluids containing hazardous substances
16 01 15	antifreeze fluids other than those mentioned in 16 01 14
16 01 17	ferrous metal
16 01 18	non-ferrous metal
16 01 19	plastic
16 01 20	glass
16 01 21*	hazardous components other than those mentioned in 16 01 07 to 16 01 11 and 16 01 13 and 16 01 14
16 01 22	components not otherwise specified
<b>16 02</b>	<b>wastes from electrical and electronic equipment</b>
16 02 09*	transformers and capacitors containing PCBs
16 02 10*	discarded equipment containing or contaminated by PCBs other than those mentioned in 16 02 09
16 02 11*	discarded equipment containing chlorofluorocarbons, HCFC, HFC
16 02 12*	discarded equipment containing free asbestos
16 02 13*	discarded equipment containing hazardous components other than those mentioned in 16 02 09 to 16 02 12
16 02 14	discarded equipment other than those mentioned in 16 02 09 to 16 02 13
16 02 15*	hazardous components removed from discarded equipment
16 02 16	components removed from discarded equipment other than those mentioned
<b>16 03</b>	<b>off-specification batches and unused products</b>
16 03 03*	inorganic wastes containing hazardous substances
16 03 04	inorganic wastes other than those mentioned in 16 03 03
16 03 05*	organic wastes containing hazardous substances
16 03 06	organic wastes other than those mentioned in 16 03 05
<b>16 05</b>	<b>gases in pressure containers and discarded chemicals</b>
16 05 04*	gases in pressure containers (including halons) containing hazardous substances
16 05 05	gases in pressure containers other than those mentioned in 16 05 04



<b>Table S2.2 Permitted waste types and quantities for storage</b>	
<b>Maximum quantity</b>	Non-hazardous waste storage: maximum of 670 tonnes. Hazardous waste storage: maximum of 670 tonnes. Maximum storage duration: 3 months. Notwithstanding the listed wastes below, wastes with the following Hazardous Properties are not permitted: HP1, HP9, HP15.
<b>Waste code</b>	<b>Description</b>
16 05 06*	laboratory chemicals, consisting of or containing hazardous substances, including mixtures of laboratory chemicals
16 05 07*	discarded inorganic chemicals consisting of or containing hazardous substances
16 05 08*	discarded organic chemicals consisting of or containing hazardous substances
16 05 09	discarded chemicals other than those mentioned in 16 05 06, 16 05 07 or 16 05 08
<b>16 06</b>	<b>batteries and accumulators</b>
16 06 01*	lead batteries
16 06 02*	Ni-Cd batteries
16 06 03*	mercury-containing batteries
16 06 04	alkaline batteries (except 16 06 03)
16 06 05	other batteries and accumulators
16 06 06*	separately collected electrolyte from batteries and accumulators
<b>16 07</b>	<b>wastes from transport tank, storage tank and barrel cleaning (except 05 and 13)</b>
16 07 08*	wastes containing oil
16 07 09*	wastes containing other hazardous substances
<b>16 08</b>	<b>spent catalysts</b>
16 08 04	spent fluid catalytic cracking catalysts (except 16 08 07)
16 08 06*	spent liquids used as catalysts
<b>16 09</b>	<b>oxidising substances</b>
16 09 01*	permanganates, for example potassium permanganate
16 09 03*	peroxides, for example hydrogen peroxide
<b>16 10</b>	<b>aqueous liquid wastes destined for off-site treatment</b>
16 10 01*	aqueous liquid wastes containing hazardous substances
16 10 02	aqueous liquid wastes other than those mentioned in 16 10 01
16 10 03*	aqueous concentrates containing hazardous substances
16 10 04	aqueous concentrates other than those mentioned in 16 10 03
<b>16 11</b>	<b>waste linings and refractories</b>
16 11 01*	carbon-based linings and refractories from metallurgical processes containing hazardous substances
16 11 02	carbon-based linings and refractories from metallurgical processes others than those mentioned in 16 11 01,
16 11 03*	other linings and refractories from metallurgical processes containing hazardous substances
16 11 04	other linings and refractories from metallurgical processes other than those mentioned in 16 11 03

<b>Table S2.2 Permitted waste types and quantities for storage</b>	
<b>Maximum quantity</b>	Non-hazardous waste storage: maximum of 670 tonnes. Hazardous waste storage: maximum of 670 tonnes. Maximum storage duration: 3 months. Notwithstanding the listed wastes below, wastes with the following Hazardous Properties are not permitted: HP1, HP9, HP15.
<b>Waste code</b>	<b>Description</b>
16 11 05*	linings and refractories from non metallurgical processes containing hazardous substances
16 11 06	linings and refractories from non metallurgical processes other than those mentioned in 16 11 05
<b>17</b>	<b>CONSTRUCTION AND DEMOLITION WASTES (INCLUDING EXCAVATED SOIL FROM CONTAMINATED SITES)</b>
<b>17 01</b>	<b>concrete, bricks, tiles and ceramics</b>
17 01 01	concrete
17 01 02	bricks
17 01 03	tiles and ceramics
17 01 06*	mixtures of, or separate fractions of concrete, bricks, tiles and ceramics containing hazardous substances
17 01 07	mixtures of concrete, bricks, tiles and ceramics other than those mentioned in 17 01 06
<b>17 02</b>	<b>wood, glass and plastic</b>
17 02 01	wood
17 02 02	glass
17 02 03	plastic
17 02 04*	glass, plastic and wood containing or contaminated with hazardous substances
<b>17 03</b>	<b>bituminous mixtures, coal tar and tarred products</b>
17 03 01*	bituminous mixtures containing coal tar
17 03 02	bituminous mixtures other than those mentioned in 17 03 01
17 03 03*	coal tar and tarred products
<b>17 04</b>	<b>metals (including their alloys)</b>
17 04 01	copper, bronze, brass
17 04 02	aluminium
17 04 03	lead
17 04 04	zinc
17 04 05	iron and steel
17 04 06	tin
17 04 07	mixed metals
17 04 09*	metal waste contaminated with hazardous substances
17 04 10*	cables containing oil, coal tar and other hazardous substances
17 04 11	cables other than those mentioned in 17 04 10
<b>17 05</b>	<b>soil (including excavated soil from contaminated sites), stones and dredging spoil</b>
17 05 03*	soil and stones containing hazardous substances

<b>Table S2.2 Permitted waste types and quantities for storage</b>	
<b>Maximum quantity</b>	Non-hazardous waste storage: maximum of 670 tonnes. Hazardous waste storage: maximum of 670 tonnes. Maximum storage duration: 3 months. Notwithstanding the listed wastes below, wastes with the following Hazardous Properties are not permitted: HP1, HP9, HP15.
<b>Waste code</b>	<b>Description</b>
17 05 04	soil and stones other than those mentioned in 17 05 03
17 05 07*	track ballast containing hazardous substances
17 05 08	track ballast other than those mentioned in 17 05 07
<b>17 08</b>	<b>gypsum-based construction material</b>
17 08 02	gypsum-based construction materials other than those mentioned in 17 08 01
<b>17 09</b>	<b>other construction and demolition wastes</b>
17 09 03*	other construction and demolition wastes (including mixed wastes) containing hazardous substances
17 09 04	mixed construction and demolition wastes other than those mentioned in 17 09 01, 17 09 02 and 17 09 03
<b>18</b>	<b>WASTES FROM HUMAN OR ANIMAL HEALTH CARE AND/OR RELATED RESEARCH (except kitchen and restaurant wastes not arising from immediate health care)</b>
<b>18 01</b>	<b>wastes from natal care, diagnosis, treatment or prevention of disease in humans</b>
18 01 01	sharps (except 18 01 03)
<b>19</b>	<b>WASTES FROM WASTE MANAGEMENT FACILITIES, OFF-SITE WASTE WATER TREATMENT PLANTS AND THE PREPARATION OF WATER INTENDED FOR HUMAN CONSUMPTION AND WATER FOR INDUSTRIAL USE</b>
<b>19 01</b>	<b>wastes from incineration or pyrolysis of waste</b>
19 01 06*	aqueous liquid wastes from gas treatment and other aqueous liquid wastes
19 01 07*	solid wastes from gas treatment
19 01 10*	spent activated carbon from flue-gas treatment
<b>19 02</b>	<b>wastes from physico/chemical treatments of waste (including dechromatation, decyanidation, neutralisation)</b>
19 02 03	premixed wastes composed only of non-hazardous wastes
19 02 04*	premixed wastes composed of at least one hazardous waste
19 02 07*	oil and concentrates from separation
<b>19 07</b>	<b>landfill leachate</b>
19 07 02*	landfill leachate containing hazardous substances
19 07 03	landfill leachate other than those mentioned in 19 07 02
<b>19 08</b>	<b>wastes from waste water treatment plants not otherwise specified</b>
19 08 05	sludges from treatment of urban waste water
19 08 09	grease and oil mixture from oil/water separation containing edible oil and fats
19 08 10*	grease and oil mixture from oil/water separation other than those mentioned in 19 08 09
19 08 11*	sludges containing hazardous substances from biological treatment of industrial waste water

<b>Table S2.2 Permitted waste types and quantities for storage</b>	
<b>Maximum quantity</b>	Non-hazardous waste storage: maximum of 670 tonnes. Hazardous waste storage: maximum of 670 tonnes. Maximum storage duration: 3 months. Notwithstanding the listed wastes below, wastes with the following Hazardous Properties are not permitted: HP1, HP9, HP15.
<b>Waste code</b>	<b>Description</b>
19 08 12	sludges from biological treatment of industrial waste water other than those mentioned in 19 08 11
19 08 13*	sludges containing hazardous substances from other treatment of industrial waste water
19 08 14	sludges from other treatment of industrial waste water other than those mentioned in 19 08 13
<b>19 09</b>	<b>wastes from the preparation of water intended for human consumption or water for industrial use</b>
19 09 01	solid waste from primary filtration and screenings
19 09 04	spent activated carbon
<b>19 10</b>	<b>wastes from shredding of metal-containing wastes</b>
19 10 01	iron and steel waste
19 10 02	non-ferrous waste
<b>19 11</b>	<b>wastes from oil regeneration</b>
19 11 03*	aqueous liquid wastes
19 11 05*	sludges from on-site effluent treatment containing hazardous substances
19 11 06	sludges from on-site effluent treatment other than those mentioned in 19 11 05
<b>19 12</b>	<b>wastes from the mechanical treatment of waste (for example sorting, crushing, compacting, pelletising) not otherwise specified</b>
19 12 01	paper and cardboard
19 12 02	ferrous metal
19 12 03	non-ferrous metal
19 12 04	plastic and rubber
19 12 05	glass
19 12 06*	wood containing hazardous substances
19 12 07	wood other than that mentioned in 19 12 06
19 12 08	textiles
19 12 09	minerals (for example sand, stones)
19 12 11*	other wastes (including mixtures of materials) from mechanical treatment of waste containing hazardous substances
19 12 12	other wastes (including mixtures of materials) from mechanical treatment of wastes other than those mentioned in 19 12 11
<b>19 13</b>	<b>wastes from soil and groundwater remediation</b>
19 13 01*	solid wastes from soil remediation containing hazardous substances
19 13 02	solid wastes from soil remediation other than those mentioned in 19 13 01
19 13 03*	sludges from soil remediation containing hazardous substances

<b>Table S2.2 Permitted waste types and quantities for storage</b>	
<b>Maximum quantity</b>	Non-hazardous waste storage: maximum of 670 tonnes. Hazardous waste storage: maximum of 670 tonnes. Maximum storage duration: 3 months. Notwithstanding the listed wastes below, wastes with the following Hazardous Properties are not permitted: HP1, HP9, HP15.
<b>Waste code</b>	<b>Description</b>
19 13 04	sludges from soil remediation other than those mentioned in 19 13 03
19 13 05*	sludges from groundwater remediation containing hazardous substances
19 13 06	sludges from groundwater remediation other than those mentioned in 19 13 05
19 13 07*	aqueous liquid wastes and aqueous concentrates from groundwater remediation containing hazardous substances
19 13 08	aqueous liquid wastes and aqueous concentrates from groundwater remediation other than those mentioned in 19 13 07
<b>20</b>	<b>MUNICIPAL WASTES (HOUSEHOLD WASTE AND SIMILAR COMMERCIAL, INDUSTRIAL AND INSTITUTIONAL WASTES) INCLUDING SEPARATELY COLLECTED FRACTIONS</b>
<b>20 01</b>	<b>separately collected fractions (except 15 01)</b>
20 01 01	paper and cardboard
20 01 02	glass
20 01 08	biodegradable kitchen and canteen waste
20 01 10	clothes
20 01 11	textiles
20 01 13*	solvents
20 01 14*	acids
20 01 15*	alkalines
20 01 17*	photochemicals
20 01 19*	pesticides
20 01 21*	fluorescent tubes and other mercury-containing waste
20 01 23*	discarded equipment containing chlorofluorocarbons
20 01 25	edible oil and fat
20 01 26*	oil and fat other than those mentioned in 20 01 25
20 01 27*	paint, inks, adhesives and resins containing hazardous substances
20 01 28	paint, inks, adhesives and resins other than those mentioned in 20 01 27
20 01 29*	detergents containing hazardous substances
20 01 30	detergents other than those mentioned in 20 01 29
20 01 33*	batteries and accumulators included in 16 06 01, 16 06 02 or 16 06 03 and unsorted batteries and accumulators containing these batteries
20 01 34	batteries and accumulators other than those mentioned in 20 01 33
20 01 35*	discarded electrical and electronic equipment other than those mentioned in 20 01 21 and 20 01 23 containing hazardous components
20 01 36	discarded electrical and electronic equipment other than those mentioned in 20 01 21, 20 01 23 and 20 01 35

<b>Table S2.2 Permitted waste types and quantities for storage</b>	
<b>Maximum quantity</b>	Non-hazardous waste storage: maximum of 670 tonnes. Hazardous waste storage: maximum of 670 tonnes. Maximum storage duration: 3 months. Notwithstanding the listed wastes below, wastes with the following Hazardous Properties are not permitted: HP1, HP9, HP15.
<b>Waste code</b>	<b>Description</b>
20 01 37*	wood containing hazardous substances
20 01 38	wood other than that mentioned in 20 01 37
20 01 39	plastics
20 01 40	metals
<b>20 03</b>	<b>other municipal wastes</b>
20 03 01	mixed municipal waste
20 03 03	street-cleaning residues
20 03 07	bulky waste

<b>Table S2.3 Permitted waste types and quantities for phase separation and filtration</b>	
<b>Maximum quantity</b>	Treatment Capacity: maximum of 200 tonnes/day. Notwithstanding the listed wastes below, wastes with the following Hazardous Properties are not permitted: HP1, HP2, HP3, HP8, HP9, HP12, HP15, wastes which contain Persistent Organic Pollutants (POPs).
<b>Waste code</b>	<b>Description</b>
<b>01</b>	<b>WASTES RESULTING FROM EXPLORATION, MINING, QUARRYING, AND PHYSICAL AND CHEMICAL TREATMENT OF MINERALS</b>
<b>01 01</b>	<b>wastes from mineral excavation</b>
01 01 01	wastes from mineral metalliferous excavation
01 01 02	wastes from mineral non-metalliferous excavation
<b>01 04</b>	<b>wastes from physical and chemical processing of non-metalliferous minerals</b>
01 04 07*	wastes containing hazardous substances from physical and chemical processing of non-metalliferous minerals
01 04 13	wastes from stone cutting and sawing other than those mentioned in 01 04 07
<b>01 05</b>	<b>drilling muds and other drilling wastes</b>
01 05 04	freshwater drilling muds and wastes
01 05 05*	oil-containing drilling muds and wastes
01 05 06*	drilling muds and other drilling wastes containing hazardous substances
<b>02</b>	<b>WASTES FROM AGRICULTURE, HORTICULTURE, AQUACULTURE, FORESTRY, HUNTING AND FISHING, FOOD PREPARATION AND PROCESSING</b>
<b>02 01</b>	<b>wastes from agriculture, horticulture, aquaculture, forestry, hunting and fishing</b>
02 01 01	sludges from washing and cleaning
02 01 08*	agrochemical waste containing hazardous substances
02 01 09	agrochemical waste other than those mentioned in 02 01 08
<b>02 02</b>	<b>wastes from the preparation and processing of meat, fish and other foods of animal origin</b>

<b>Table S2.3 Permitted waste types and quantities for phase separation and filtration</b>	
<b>Maximum quantity</b>	Treatment Capacity: maximum of 200 tonnes/day. Notwithstanding the listed wastes below, wastes with the following Hazardous Properties are not permitted: HP1, HP2, HP3, HP8, HP9, HP12, HP15, wastes which contain Persistent Organic Pollutants (POPs).
<b>Waste code</b>	<b>Description</b>
02 02 01	sludges from washing and cleaning
02 02 04	sludges from on-site effluent treatment
<b>02 03</b>	<b>wastes from fruit, vegetables, cereals, edible oils, cocoa, coffee, tea and tobacco preparation and processing; conserve production; yeast and yeast extract production, molasses preparation and fermentation</b>
02 03 01	sludges from washing, cleaning, peeling, centrifuging and separation
02 03 02	wastes from preserving agents
02 03 04	materials unsuitable for consumption or processing
02 03 05	sludges from on-site effluent treatment
<b>02 04</b>	<b>wastes from sugar processing</b>
02 04 03	sludges from on-site effluent treatment
<b>02 05</b>	<b>wastes from the dairy products industry</b>
02 05 01	materials unsuitable for consumption or processing
02 05 02	sludges from on-site effluent treatment
<b>02 06</b>	<b>wastes from the baking and confectionery industry</b>
02 06 01	materials unsuitable for consumption or processing
02 06 02	wastes from preserving agents
02 06 03	sludges from on-site effluent treatment
<b>02 07</b>	<b>wastes from the production of alcoholic and non-alcoholic beverages (except coffee, tea and cocoa)</b>
02 07 01	wastes from washing, cleaning and mechanical reduction of raw materials
02 07 04	materials unsuitable for consumption or processing
02 07 05	sludges from on-site effluent treatment
<b>03</b>	<b>WASTES FROM WOOD PROCESSING AND THE PRODUCTION OF PANELS AND FURNITURE, PULP, PAPER AND CARDBOARD</b>
<b>03 03</b>	<b>wastes from pulp, paper and cardboard production and processing</b>
03 03 05	de-inking sludges from paper recycling
03 03 11	sludges from on-site effluent treatment other than those mentioned in 03 03 10
<b>04</b>	<b>WASTES FROM THE LEATHER, FUR AND TEXTILE INDUSTRIES</b>
<b>04 02</b>	<b>wastes from the textile industry</b>
04 02 16*	dyestuffs and pigments containing hazardous substances
04 02 17	dyestuffs and pigments other than those mentioned in 04 02 16
04 02 19*	sludges from on-site effluent treatment containing hazardous substances
04 02 20	sludges from on-site effluent treatment other than those mentioned in 04 02 19
<b>05</b>	<b>WASTES FROM PETROLEUM REFINING, NATURAL GAS PURIFICATION AND PYROLYTIC TREATMENT OF COAL</b>
<b>05 01</b>	<b>wastes from petroleum refining</b>

<b>Table S2.3 Permitted waste types and quantities for phase separation and filtration</b>	
<b>Maximum quantity</b>	Treatment Capacity: maximum of 200 tonnes/day. Notwithstanding the listed wastes below, wastes with the following Hazardous Properties are not permitted: HP1, HP2, HP3, HP8, HP9, HP12, HP15, wastes which contain Persistent Organic Pollutants (POPs).
<b>Waste code</b>	<b>Description</b>
05 01 03*	tank bottom sludges
05 01 05*	oil spills
05 01 06*	oily sludges from maintenance operations of the plant or equipment
05 01 09*	sludges from on-site effluent treatment containing hazardous substances
05 01 14	wastes from cooling columns
<b>05 06</b>	<b>wastes from the pyrolytic treatment of coal</b>
05 06 04	wastes from cooling columns
<b>06</b>	<b>WASTES FROM INORGANIC CHEMICAL PROCESSES</b>
<b>06 05</b>	<b>sludges from on-site effluent treatment</b>
06 05 02*	sludges from on-site effluent treatment containing hazardous substances
06 05 03	sludges from on-site effluent treatment other than those mentioned in 06 05 02
<b>07</b>	<b>WASTES FROM ORGANIC CHEMICAL PROCESSES</b>
<b>07 01</b>	<b>wastes from the manufacture, formulation, supply and use (MFSU) of basic organic chemicals</b>
07 01 01*	aqueous washing liquids and mother liquors
07 01 11*	sludges from on-site effluent treatment containing hazardous substances
07 01 12	sludges from on-site effluent treatment other than those mentioned in 07 01 11
<b>07 02</b>	<b>wastes from the MFSU of plastics, synthetic rubber and man-made fibres</b>
07 02 11*	sludges from on-site effluent treatment containing hazardous substances
07 02 12	sludges from on-site effluent treatment other than those mentioned in 07 02 11
<b>07 03</b>	<b>wastes from the MFSU of organic dyes and pigments (except 06 11)</b>
07 03 01*	aqueous washing liquids and mother liquors
07 03 11*	sludges from on-site effluent treatment containing hazardous substances
07 03 12	sludges from on-site effluent treatment other than those mentioned in 07 03 11
<b>07 04</b>	<b>wastes from the MFSU of organic plant protection products (except 02 01 08 and 02 01 09), wood preserving agents (except 03 02) and other biocides</b>
07 04 01*	aqueous washing liquids and mother liquors
07 04 11*	sludges from on-site effluent treatment containing hazardous substances
07 04 12	sludges from on-site effluent treatment other than those mentioned in 07 04 11
<b>07 05</b>	<b>wastes from the MFSU of pharmaceuticals</b>
07 05 01*	aqueous washing liquids and mother liquors
07 05 11*	sludges from on-site effluent treatment containing hazardous substances
07 05 12	sludges from on-site effluent treatment other than those mentioned in 07 05 11
<b>07 06</b>	<b>wastes from the MFSU of fats, grease, soaps, detergents, disinfectants and cosmetics</b>
07 06 01*	aqueous washing liquids and mother liquors



<b>Table S2.3 Permitted waste types and quantities for phase separation and filtration</b>	
<b>Maximum quantity</b>	Treatment Capacity: maximum of 200 tonnes/day. Notwithstanding the listed wastes below, wastes with the following Hazardous Properties are not permitted: HP1, HP2, HP3, HP8, HP9, HP12, HP15, wastes which contain Persistent Organic Pollutants (POPs).
<b>Waste code</b>	<b>Description</b>
07 06 12	sludges from on-site effluent treatment other than those mentioned in 07 06 11
<b>07 07</b>	<b>wastes from the MFSU of fine chemicals and chemical products not otherwise specified</b>
07 07 01*	aqueous washing liquids and mother liquors
07 07 12	sludges from on-site effluent treatment other than those mentioned in 07 07 11
<b>08</b>	<b>WASTES FROM THE MANUFACTURE, FORMULATION, SUPPLY AND USE (MFSU) OF COATINGS (PAINTS, VARNISHES AND VITREOUS ENAMELS), ADHESIVES, SEALANTS AND PRINTING INKS</b>
<b>08 01</b>	<b>wastes from MFSU and removal of paint and varnish</b>
08 01 11*	waste paint and varnish containing organic solvents or other dangerous substances
08 01 12	waste paint and varnish other than those mentioned in 08 01 11
08 01 14	sludges from paint or varnish other than those mentioned in 08 01 13
08 01 15*	aqueous sludges containing paint or varnish containing organic solvents or other dangerous substances
08 01 16	aqueous sludges containing paint or varnish other than those mentioned in 08 01 15
08 01 18	wastes from paint or varnish removal other than those mentioned in 08 01 17
08 01 19*	aqueous suspensions containing paint or varnish containing organic solvents or other hazardous substances
08 01 20	aqueous suspensions containing paint or varnish other than those mentioned in 08 01 19
<b>08 02</b>	<b>wastes from MFSU of other coatings (including ceramic materials)</b>
08 02 02	aqueous sludges containing ceramic materials
08 02 03	aqueous suspensions containing ceramic materials
<b>08 03</b>	<b>wastes from MFSU of printing inks</b>
08 03 07	aqueous sludges containing ink
08 03 08	aqueous liquid waste containing ink
08 03 12*	waste ink containing hazardous substances
08 03 13	waste ink other than those mentioned in 08 03 12
08 03 14*	ink sludges containing hazardous substances
08 03 15	ink sludges other than those mentioned in 08 03 14
<b>08 04</b>	<b>wastes from MFSU of adhesives and sealants (including waterproofing products)</b>
08 04 09*	waste adhesives and sealants containing organic solvents or other hazardous substances
08 04 10	waste adhesives and sealants other than those mentioned in 08 04 09
08 04 11*	adhesive and sealant sludges containing organic solvents or other hazardous substances
08 04 12	adhesive and sealant sludges other than those mentioned in 08 04 11

<b>Table S2.3 Permitted waste types and quantities for phase separation and filtration</b>	
<b>Maximum quantity</b>	Treatment Capacity: maximum of 200 tonnes/day. Notwithstanding the listed wastes below, wastes with the following Hazardous Properties are not permitted: HP1, HP2, HP3, HP8, HP9, HP12, HP15, wastes which contain Persistent Organic Pollutants (POPs).
<b>Waste code</b>	<b>Description</b>
08 04 13*	aqueous sludges containing adhesives or sealants containing organic solvents or other hazardous substances
08 04 14	aqueous sludges containing adhesives or sealants other than those mentioned in 08 04 13
08 04 15*	aqueous liquid waste containing adhesives or sealants containing organic solvents or other hazardous substances
08 04 16	aqueous liquid waste containing adhesives or sealants other than those mentioned in 08 04 15
<b>09</b>	<b>WASTES FROM THE PHOTOGRAPHIC INDUSTRY</b>
<b>09 01</b>	<b>wastes from the photographic industry</b>
09 01 01*	water-based developer and activator solutions
09 01 02*	water-based offset plate developer solutions
09 01 04*	fixer solutions
<b>10</b>	<b>WASTES FROM THERMAL PROCESSES</b>
<b>10 01</b>	<b>wastes from power stations and other combustion plants (except 19)</b>
10 01 20*	sludges from on-site effluent treatment containing hazardous substances
10 01 21	sludges from on-site effluent treatment other than those mentioned in 10 01 20
10 01 22*	aqueous sludges from boiler cleansing containing hazardous substances
10 01 23	aqueous sludges from boiler cleansing other than those mentioned in 10 01 22
10 01 26	wastes from cooling-water treatment
<b>10 02</b>	<b>wastes from the iron and steel industry</b>
10 02 11*	wastes from cooling-water treatment containing oil
10 02 12	wastes from cooling-water treatment other than those mentioned in 10 02 11
<b>10 03</b>	<b>wastes from aluminium thermal metallurgy</b>
10 03 27*	wastes from cooling-water treatment containing oil
10 03 28	wastes from cooling-water treatment other than those mentioned in 10 03 27
<b>10 04</b>	<b>wastes from lead thermal metallurgy</b>
10 04 09	wastes from cooling-water treatment containing oil
10 04 10	wastes from cooling-water treatment other than those mentioned in 10 04 09
<b>10 05</b>	<b>wastes from zinc thermal metallurgy</b>
10 05 08*	wastes from cooling-water treatment containing oil
10 05 09	wastes from cooling-water treatment other than those mentioned in 10 05 08
<b>10 06</b>	<b>wastes from copper thermal metallurgy</b>
10 06 09*	wastes from cooling-water treatment containing oil
10 06 10	wastes from cooling-water treatment other than those mentioned in 10 06 09
<b>10 07</b>	<b>wastes from silver, gold and platinum thermal metallurgy</b>

<b>Table S2.3 Permitted waste types and quantities for phase separation and filtration</b>	
<b>Maximum quantity</b>	Treatment Capacity: maximum of 200 tonnes/day. Notwithstanding the listed wastes below, wastes with the following Hazardous Properties are not permitted: HP1, HP2, HP3, HP8, HP9, HP12, HP15, wastes which contain Persistent Organic Pollutants (POPs).
<b>Waste code</b>	<b>Description</b>
10 07 07*	wastes from cooling-water treatment containing oil
10 07 08	wastes from cooling water treatment other than those mentioned in 10 07 07
<b>10 08</b>	<b>wastes from other non-ferrous thermal metallurgy</b>
10 08 19*	wastes from cooling-water treatment containing oil
10 08 20	wastes from cooling-water treatment other than those mentioned in 10 08 19
<b>10 12</b>	<b>wastes from manufacture of ceramic goods, bricks, tiles and construction products</b>
10 12 13	wastes from on-site effluent treatment
<b>11</b>	<b>WASTES FROM CHEMICAL SURFACE TREATMENT AND COATING OF METALS AND OTHER MATERIALS; NON-FERROUS HYDRO-METALLURGY</b>
<b>11 01</b>	<b>Wastes from chemical surface treatment and coating of metals and other materials (for example galvanic processes, zinc coating processes, pickling processes, etching, phosphating, alkaline degreasing, anodising)</b>
11 01 11*	aqueous rinsing liquids containing hazardous substances
11 01 12	aqueous rinsing liquids other than those mentioned in 11 01 11
11 01 13*	degreasing wastes containing hazardous substances
11 01 14	degreasing wastes other than those mentioned in 11 01 12
<b>12</b>	<b>WASTES FROM SHAPING AND PHYSICAL AND MECHANICAL SURFACE TREATMENT OF METALS AND PLASTICS</b>
<b>12 01</b>	<b>wastes from shaping and physical and mechanical surface treatment of metals and plastics</b>
12 01 07*	mineral-based machining oils free of halogens (except emulsions and solutions)
12 01 09*	machining emulsions and solutions free of halogens
12 01 10*	synthetic machining oils
12 01 19*	readily biodegradable machining oil
<b>12 03</b>	<b>wastes from water and steam degreasing processes (except 11)</b>
12 03 01*	aqueous washing liquids
12 03 02*	steam degreasing wastes
<b>13</b>	<b>OIL WASTES AND WASTES OF LIQUID FUELS (except edible oils, and those in chapters 05, 12 and 19)</b>
<b>13 01</b>	<b>waste hydraulic oils</b>
13 01 04*	chlorinated emulsions
13 01 05*	non-chlorinated emulsions
13 01 09*	mineral-based chlorinated hydraulic oils
13 01 10*	mineral based non-chlorinated hydraulic oils
13 01 11*	synthetic hydraulic oils
13 01 12*	readily biodegradable hydraulic oils

<b>Table S2.3 Permitted waste types and quantities for phase separation and filtration</b>	
<b>Maximum quantity</b>	Treatment Capacity: maximum of 200 tonnes/day. Notwithstanding the listed wastes below, wastes with the following Hazardous Properties are not permitted: HP1, HP2, HP3, HP8, HP9, HP12, HP15, wastes which contain Persistent Organic Pollutants (POPs).
<b>Waste code</b>	<b>Description</b>
13 01 13*	other hydraulic oils
<b>13 02</b>	<b>waste engine, gear and lubricating oils</b>
13 02 04*	mineral-based chlorinated engine, gear and lubricating oils
13 02 05*	mineral-based non-chlorinated engine, gear and lubricating oils
13 02 06*	synthetic engine, gear and lubricating oils
13 02 07*	readily biodegradable engine, gear and lubricating oils
13 02 08*	other engine, gear and lubricating oils
<b>13 03</b>	<b>waste insulating and heat transmission oils</b>
13 03 06*	mineral-based chlorinated insulating and heat transmission oils other than those mentioned in 13 03 01
13 03 07*	mineral-based non-chlorinated insulating and heat transmission oils
13 03 08*	synthetic insulating and heat transmission oils
13 03 09*	readily biodegradable insulating and heat transmission oils
13 03 10*	other insulating and heat transmission oils
<b>13 04</b>	<b>bilge oils</b>
13 04 01*	bilge oils from inland navigation
13 04 02*	bilge oils from jetty sewers
13 04 03*	bilge oils from other navigation
<b>13 05</b>	<b>oil/water separator contents</b>
13 05 01*	solids from grit chambers and oil/water separators
13 05 02*	sludges from oil/water separators
13 05 03*	interceptor sludges
13 05 06*	oil from oil/water separators
13 05 07*	oily water from oil/water separators
13 05 08*	mixtures of wastes from grit chambers and oil/water separators
<b>13 07</b>	<b>wastes of liquid fuels</b>
13 07 01*	fuel oil and diesel
<b>16</b>	<b>WASTES NOT OTHERWISE SPECIFIED IN THE LIST</b>
<b>16 01</b>	<b>end-of-life vehicles from different means of transport (including off-road machinery) and wastes from dismantling of end-of-life vehicles and vehicle maintenance (except 13, 14, 16 06 and 16 08)</b>
16 01 14*	antifreeze fluids containing hazardous substances
16 01 15	antifreeze fluids other than those mentioned in 16 01 14
<b>16 07</b>	<b>wastes from transport tank, storage tank and barrel cleaning (except 05 and 13)</b>
16 07 08*	wastes containing oil
16 07 09*	wastes containing other hazardous substances

<b>Table S2.3 Permitted waste types and quantities for phase separation and filtration</b>	
<b>Maximum quantity</b>	Treatment Capacity: maximum of 200 tonnes/day. Notwithstanding the listed wastes below, wastes with the following Hazardous Properties are not permitted: HP1, HP2, HP3, HP8, HP9, HP12, HP15, wastes which contain Persistent Organic Pollutants (POPs).
<b>Waste code</b>	<b>Description</b>
<b>16 10</b>	<b>aqueous liquid wastes destined for off-site treatment</b>
16 10 01*	aqueous liquid wastes containing hazardous substances
16 10 02	aqueous liquid wastes other than those mentioned in 16 10 01
16 10 03*	aqueous concentrates containing hazardous substances
16 10 04	aqueous concentrates other than those mentioned in 16 10 03
<b>19</b>	<b>WASTES FROM WASTE MANAGEMENT FACILITIES, OFF-SITE WASTE WATER TREATMENT PLANTS AND THE PREPARATION OF WATER INTENDED FOR HUMAN CONSUMPTION AND WATER FOR INDUSTRIAL USE</b>
<b>19 01</b>	<b>wastes from incineration or pyrolysis of waste</b>
19 01 06*	aqueous liquid wastes from gas treatment and other aqueous liquid wastes
<b>19 02</b>	<b>wastes from physico/chemical treatments of waste (including dechromatation, decyanidation, neutralisation)</b>
19 02 07*	oil and concentrates from separation
<b>19 07</b>	<b>landfill leachate</b>
19 07 02*	landfill leachate containing hazardous substances
19 07 03	landfill leachate other than those mentioned in 19 07 02
<b>19 08</b>	<b>wastes from waste water treatment plants not otherwise specified</b>
19 08 05	sludges from treatment of urban waste water
19 08 09	grease and oil mixture from oil/water separation containing edible oil and fats
19 08 10*	grease and oil mixture from oil/water separation other than those mentioned in 19 08 09
19 08 11*	sludges containing hazardous substances from biological treatment of industrial waste water
19 08 12	sludges from biological treatment of industrial waste water other than those mentioned in 19 08 11
19 08 13*	sludges containing hazardous substances from other treatment of industrial waste water
19 08 14	sludges from other treatment of industrial waste water other than those mentioned in 19 08 13
<b>19 11</b>	<b>wastes from oil regeneration</b>
19 11 03*	aqueous liquid wastes
19 11 05*	sludges from on-site effluent treatment containing hazardous substances
19 11 06	sludges from on-site effluent treatment other than those mentioned in 19 11 05
<b>19 13</b>	<b>wastes from soil and groundwater remediation</b>
19 13 04	sludges from soil remediation other than those mentioned in 19 13 03
19 13 05*	sludges from groundwater remediation containing hazardous substances
19 13 06	sludges from groundwater remediation other than those mentioned in 19 13 05
19 13 07*	aqueous liquid wastes and aqueous concentrates from groundwater remediation containing hazardous substances

<b>Table S2.3 Permitted waste types and quantities for phase separation and filtration</b>	
<b>Maximum quantity</b>	Treatment Capacity: maximum of 200 tonnes/day. Notwithstanding the listed wastes below, wastes with the following Hazardous Properties are not permitted: HP1, HP2, HP3, HP8, HP9, HP12, HP15, wastes which contain Persistent Organic Pollutants (POPs).
<b>Waste code</b>	<b>Description</b>
19 13 08	aqueous liquid wastes and aqueous concentrates from groundwater remediation other than those mentioned in 19 13 07
<b>20</b>	<b>MUNICIPAL WASTES (HOUSEHOLD WASTE AND SIMILAR COMMERCIAL, INDUSTRIAL AND INSTITUTIONAL WASTES) INCLUDING SEPARATELY COLLECTED FRACTIONS</b>
<b>20 01</b>	<b>separately collected fractions (except 15 01)</b>
20 01 26*	oil and fat other than those mentioned in 20 01 25
20 01 27*	paint, inks, adhesives and resins containing hazardous substances
20 01 28	paint, inks, adhesives and resins other than those mentioned in 20 01 27
<b>20 03</b>	<b>other municipal wastes</b>
20 03 03	street-cleaning residues

## Schedule 3 – Emissions and monitoring

<b>Emission point ref. &amp; location</b>	<b>Source</b>	<b>Parameter</b>	<b>Limit (including unit)</b>	<b>Reference period</b>	<b>Monitoring frequency</b>	<b>Monitoring standard or method</b>
A4, A5, A6, A7, A8 on site plan in Schedule 7	Tank vents on the tank farm serving the Ultrafiltration plant	--	--	--	--	--

<b>Emission point ref. &amp; location</b>	<b>Source</b>	<b>Parameter</b>	<b>Limit (incl. Unit)</b>	<b>Reference period</b>	<b>Monitoring frequency</b>	<b>Monitoring standard or method</b>
S1 on site plan in schedule 7 emission to Yorkshire Water Knostrop Sewage Treatment Works	Ultrafiltration plant permeate	--	--	--	--	--

## Schedule 4 – Reporting

Parameters, for which reports shall be made, in accordance with conditions of this permit, are listed below.

<b>Table S4.1 Performance parameters</b>		
<b>Parameter</b>	<b>Frequency of assessment</b>	<b>Units</b>
Water usage	Annually	m <sup>3</sup>
Energy usage	Annually	MWh

<b>Table S4.2 Reporting forms</b>		
<b>Media/parameter</b>	<b>Reporting format</b>	<b>Date of form</b>
Water usage	Form water usage 1 or other form as agreed in writing by the Environment Agency	23/02/2016
Energy usage	Form energy 1 or other form as agreed in writing by the Environment Agency	23/02/2016



# Schedule 5 – Notification

These pages outline the information that the operator must provide.

Units of measurement used in information supplied under Part A and B requirements shall be appropriate to the circumstances of the emission. Where appropriate, a comparison should be made of actual emissions and authorised emission limits.

If any information is considered commercially confidential, it should be separated from non-confidential information, supplied on a separate sheet and accompanied by an application for commercial confidentiality under the provisions of the EP Regulations.

## Part A

Permit Number	
Name of operator	
Location of Facility	
Time and date of the detection	

<b>(a) Notification requirements for any malfunction, breakdown or failure of equipment or techniques, accident, or emission of a substance not controlled by an emission limit which has caused, is causing or may cause significant pollution</b>	
<b>To be notified within 24 hours of detection</b>	
Date and time of the event	
Reference or description of the location of the event	
Description of where any release into the environment took place	
Substances(s) potentially released	
Best estimate of the quantity or rate of release of substances	
Measures taken, or intended to be taken, to stop any emission	
Description of the failure or accident.	

<b>(b) Notification requirements for the breach of a limit</b>	
<b>To be notified within 24 hours of detection unless otherwise specified below</b>	
Emission point reference/source	
Parameter(s)	
Limit	
Measured value and uncertainty	
Date and time of monitoring	

<b>(b) Notification requirements for the breach of a limit</b>	
<b>To be notified within 24 hours of detection unless otherwise specified below</b>	
Measures taken, or intended to be taken, to stop the emission	

<b>Time periods for notification following detection of a breach of a limit</b>	
<b>Parameter</b>	<b>Notification period</b>

<b>(c) Notification requirements for the detection of any significant adverse environmental effect</b>	
<b>To be notified within 24 hours of detection</b>	
Description of where the effect on the environment was detected	
Substances(s) detected	
Concentrations of substances detected	
Date of monitoring/sampling	

## Part B – to be submitted as soon as practicable

Any more accurate information on the matters for notification under Part A.	
Measures taken, or intended to be taken, to prevent a recurrence of the incident	
Measures taken, or intended to be taken, to rectify, limit or prevent any pollution of the environment which has been or may be caused by the emission	
The dates of any unauthorised emissions from the facility in the preceding 24 months.	

Name*	
Post	
Signature	
Date	

\* authorised to sign on behalf of the operator

## Schedule 6 – Interpretation

“accident” means an accident that may result in pollution.

“Annex I” means Annex I to Directive 2008/98/EC of the European Parliament and of the Council on waste.

“Annex II” means Annex II to Directive 2008/98/EC of the European Parliament and of the Council on waste.

“application” means the application for this permit, together with any additional information supplied by the operator as part of the application and any response to a notice served under Schedule 5 to the EP Regulations.

“authorised officer” means any person authorised by the Environment Agency under section 108(1) of The Environment Act 1995 to exercise, in accordance with the terms of any such authorisation, any power specified in section 108(4) of that Act.

“D” means a disposal operation provided for in Annex I to Directive 2008/98/EC of the European Parliament and of the Council on waste.

“disposal” means any of the operations provided for in Annex I to Directive 2008/98/EC of the European Parliament and of the Council on waste.

“emissions of substances not controlled by emission limits” means emissions of substances to air, water or land from the activities, either from the emission points specified in schedule 3 or from other localised or diffuse sources, which are not controlled by an emission limit.

“emissions to land” includes emissions to groundwater.

“EP Regulations” means The Environmental Permitting (England and Wales) Regulations SI 2010 No. 675 and words and expressions used in this permit which are also used in the Regulations have the same meanings as in those Regulations.

“groundwater” means all water, which is below the surface of the ground in the saturation zone and in direct contact with the ground or subsoil.

“Hazardous property” has the meaning in Annex III of the Waste Framework Directive.

“Hazardous waste” has the meaning given in the Hazardous Waste (England and Wales) Regulations 2005 (as amended).

“impermeable surface” means a surface or pavement constructed and maintained to a standard sufficient to prevent the transmission of liquids beyond the pavement surface, and should be read in conjunction with the term “sealed drainage system”.

“Industrial Emissions Directive” means Directive 2010/75/EU of the European Parliament and of the Council of 24 November 2010 on industrial emissions.

“List of Wastes” means the list of wastes established by Commission Decision 2000/532/EC replacing Decision 94/3/EC establishing a list of wastes pursuant to Article 1(a) of Council Directive 75/442/EEC on waste and Council Decision 94/904/EC establishing a list of hazardous waste pursuant to Article 1(4) of Council Directive 91/689/EEC on hazardous waste, as amended from time to time.

“MCERTS” means the Environment Agency’s Monitoring Certification Scheme.

“pests” means Birds, Vermin and Insects.

“quarter” means a calendar year quarter commencing on 1 January, 1 April, 1 July or 1 October.

“R” means a recovery operation provided for in Annex II to Directive 2008/98/EC of the European Parliament and of the Council on waste.

“recovery” means any of the operations provided for in Annex II to Directive 2008/98/EC of the European Parliament and of the Council on waste.

“sealed drainage system” in relation to an impermeable surface, means a drainage system with impermeable components which does not leak and which will ensure that:

- (a) no liquid will run off the surface otherwise than via the system;
- (b) except where they may lawfully be discharged to foul sewer, all liquids entering the system are collected in a sealed sump.

“Waste code” means the six digit code referable to a type of waste in accordance with the List of Wastes and in relation to hazardous waste, includes the asterisk.

“Waste Framework Directive” or “WFD” means Waste Framework Directive 2008/98/EC of the European Parliament and of the Council on waste.

“WEEE” means waste electrical and electronic equipment.

“WEEE Directive” means Directive 2012/19/EU of the European Parliament and of the Council of 4th July 2012 on waste electrical and electronic equipment (WEEE).

“year” means calendar year ending 31 December.

Where the following terms appear in the waste code list in tables S2.2 and S2.3 they have the meaning given below:

‘hazardous substance’ means a substance classified as hazardous as a consequence of fulfilling the criteria laid down in parts 2 to 5 of Annex I to Regulation (EC) No 1272/2008.

‘heavy metal’ means any compound of antimony, arsenic, cadmium, chromium (VI), copper, lead, mercury, nickel, selenium, tellurium, thallium and tin, as well as these materials in metallic form, as far as these are classified as hazardous substances.

‘polychlorinated biphenyls and polychlorinated terphenyls’ (‘PCBs’) means PCBs as defined in Article 2(a) of Council Directive 96/59/EC’.

Article 2(a) says that ‘PCBs’ means:

- polychlorinated biphenyls;
- polychlorinated terphenyls;
- monomethyl-tetrachlorodiphenyl methane, Monomethyl-dichloro-diphenyl methane, Monomethyldibromo-diphenyl methane;
- any mixture containing any of the above mentioned substances in a total of more than 0.005% by weight.

‘transition metals’ means any of the following metals: any compound of scandium, vanadium, manganese, cobalt, copper, yttrium, niobium, hafnium, tungsten, titanium, chromium, iron, nickel, zinc, zirconium, molybdenum and tantalum, as well as these materials in metallic form, as far as these are classified as hazardous substances.

‘stabilisation’ means processes which change the hazardousness of the constituents in the waste and transform hazardous waste into non-hazardous waste.

‘solidification’ means processes which only change the physical state of the waste by using additives without changing the chemical properties of the waste.

‘partly stabilised wastes’ means wastes containing, after the stabilisation process, hazardous constituents which have not been changed completely into non-hazardous constituents and could be released into the environment in the short, middle or long term.

Where a minimum limit is set for any emission parameter, for example pH, reference to exceeding the limit shall mean that the parameter shall not be less than that limit.

Unless otherwise stated, any references in this permit to concentrations of substances in emissions into air means:

- in relation to emissions from combustion processes, the concentration in dry air at a temperature of 273K, at a pressure of 101.3 kPa and with an oxygen content of 3% dry for liquid and gaseous fuels, 6% dry for solid fuels; and/or
- in relation to emissions from non-combustion sources, the concentration at a temperature of 273K and at a pressure of 101.3 kPa, with no correction for water vapour content.

# Schedule 7 – Site plan

## Site Boundary Plan

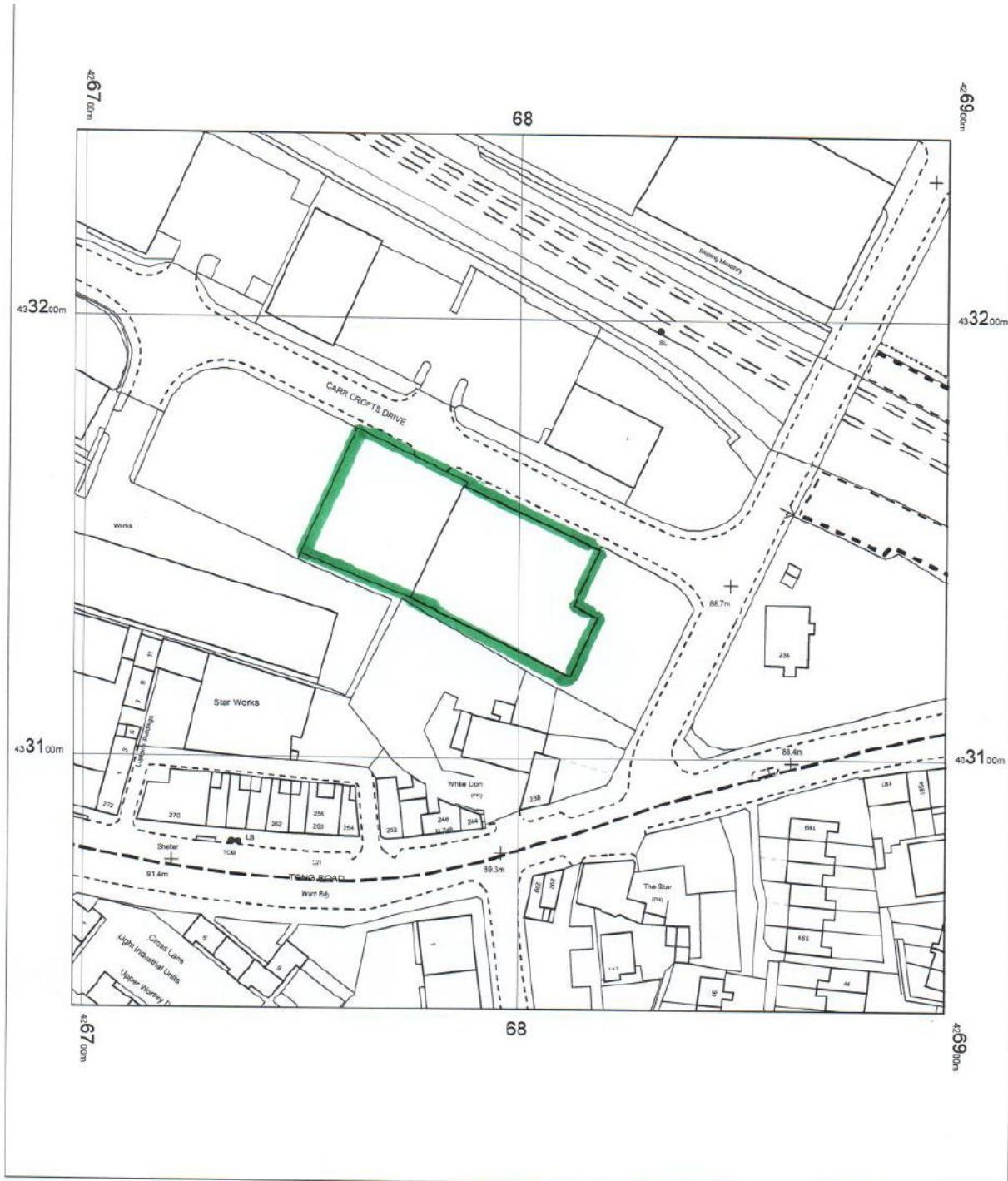

10 CARR CROFTS DRIVE  
 ARMLEY  
 LEEDS  
 LS12 3AL

OS MasterMap 1250/2500/10000 scale  
 29 January 2015, ID: BW1-00396476  
 www.blackwellmapping.co.uk  
 1:1250 scale print at A4, Centre: 426798 E, 433142 N



**BLACKWELL'S**  
 www.blackwellmapping.co.uk

# Site Layout Plan

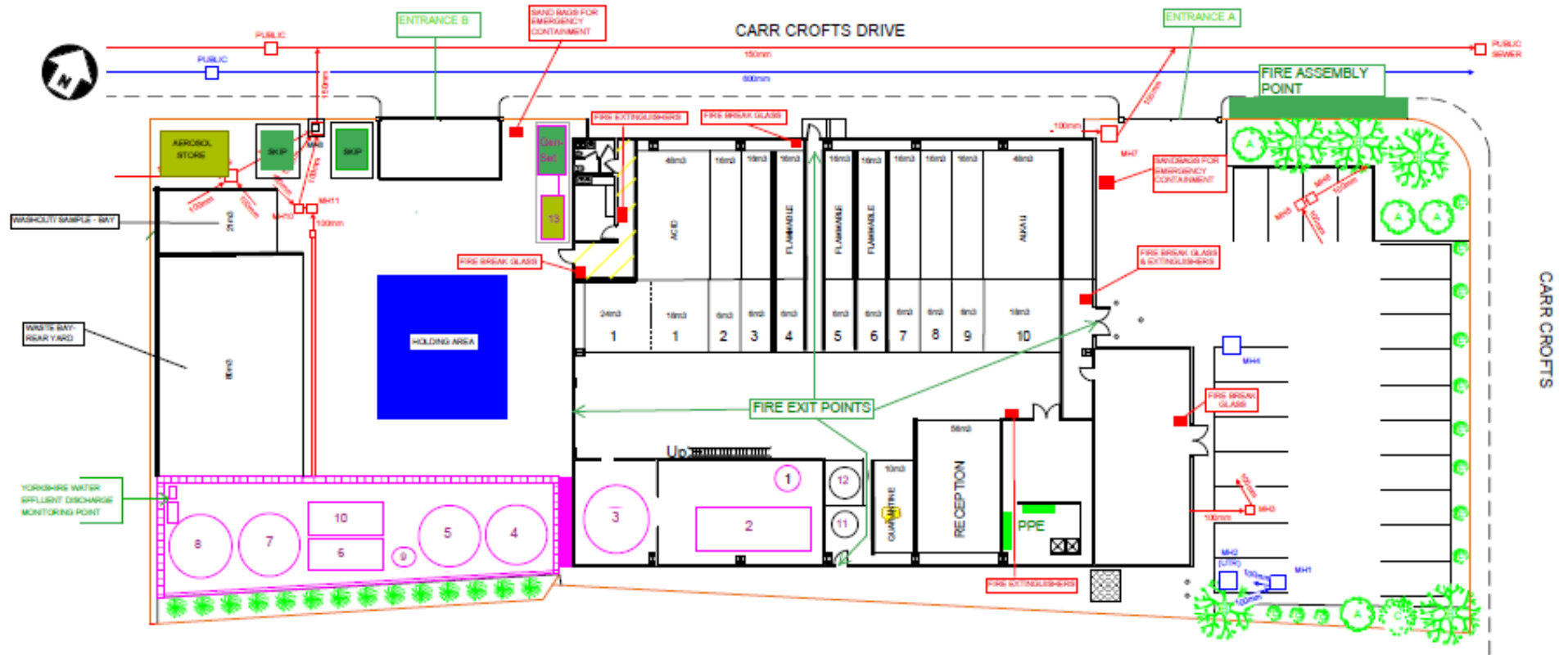

END OF PERMIT